

C-3207

ENGINE, RIGHT VIEW - Models 16GG, 56G, 57G

ENGINE

Plate 01-2

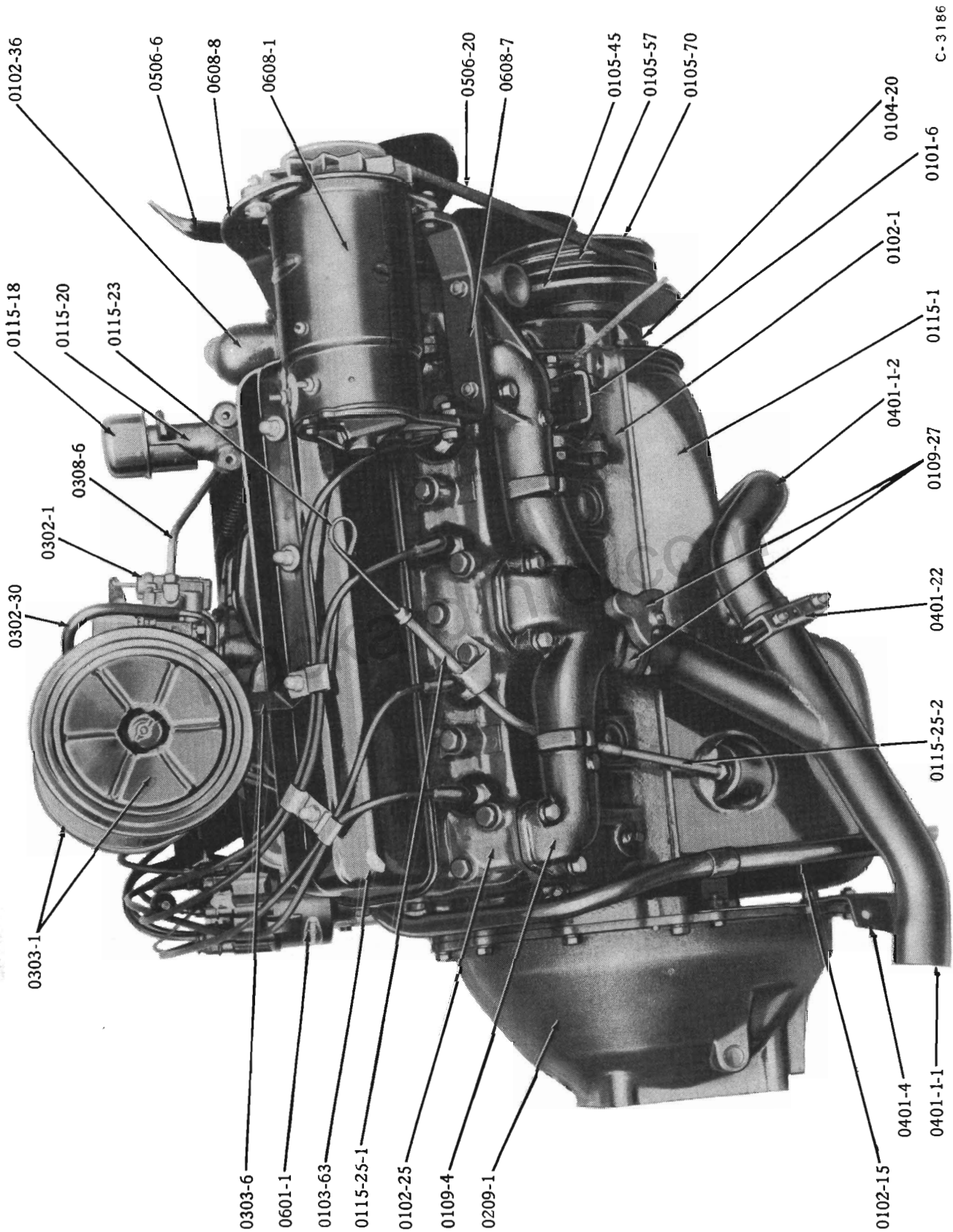

C-3186

ENGINE, RIGHT VIEW - Models 16G8, 56B, 57B

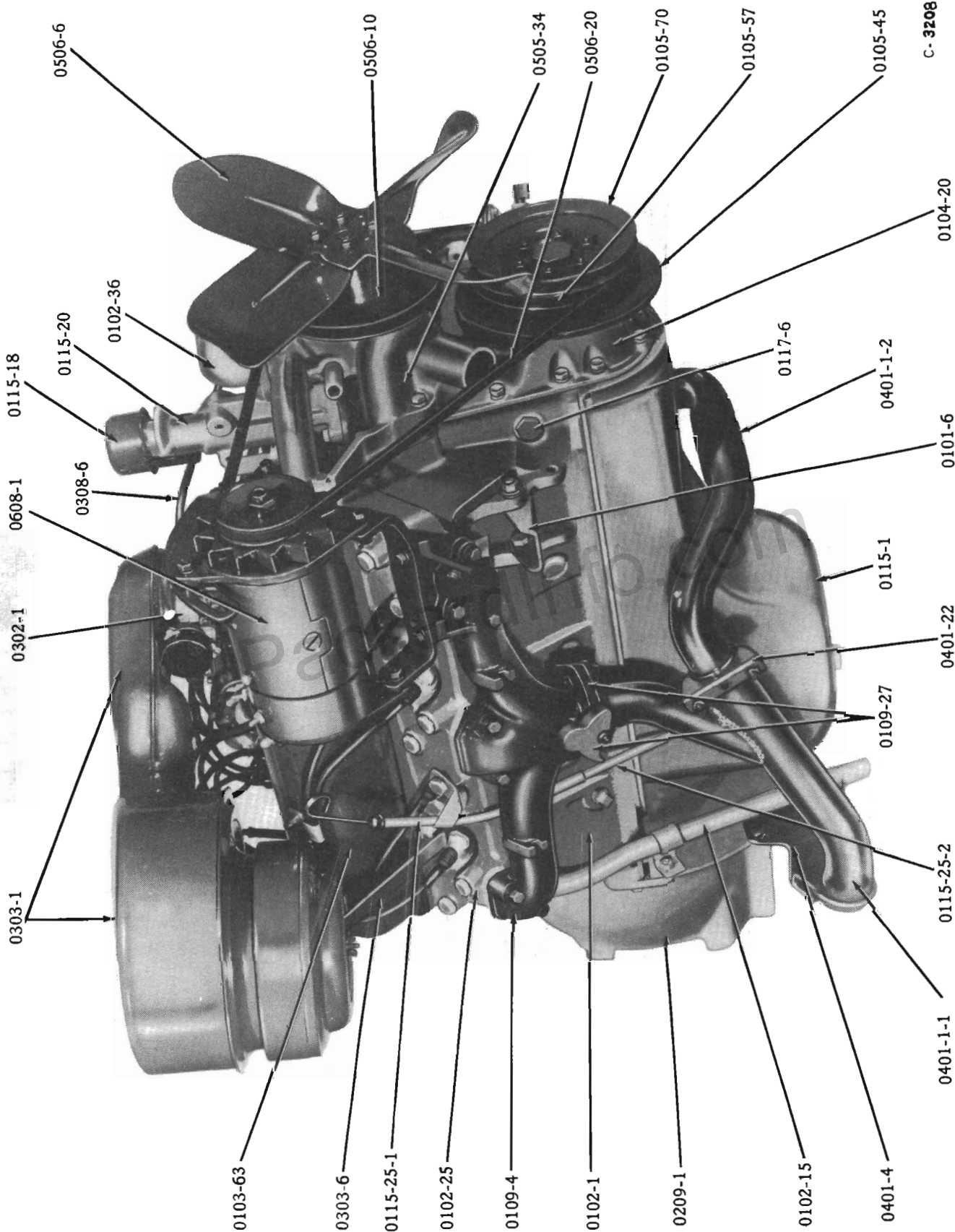

ENGINE, RIGHT VIEW - Models 6H, 56H, 57H, 57L

ENGINE

Plate 01-4

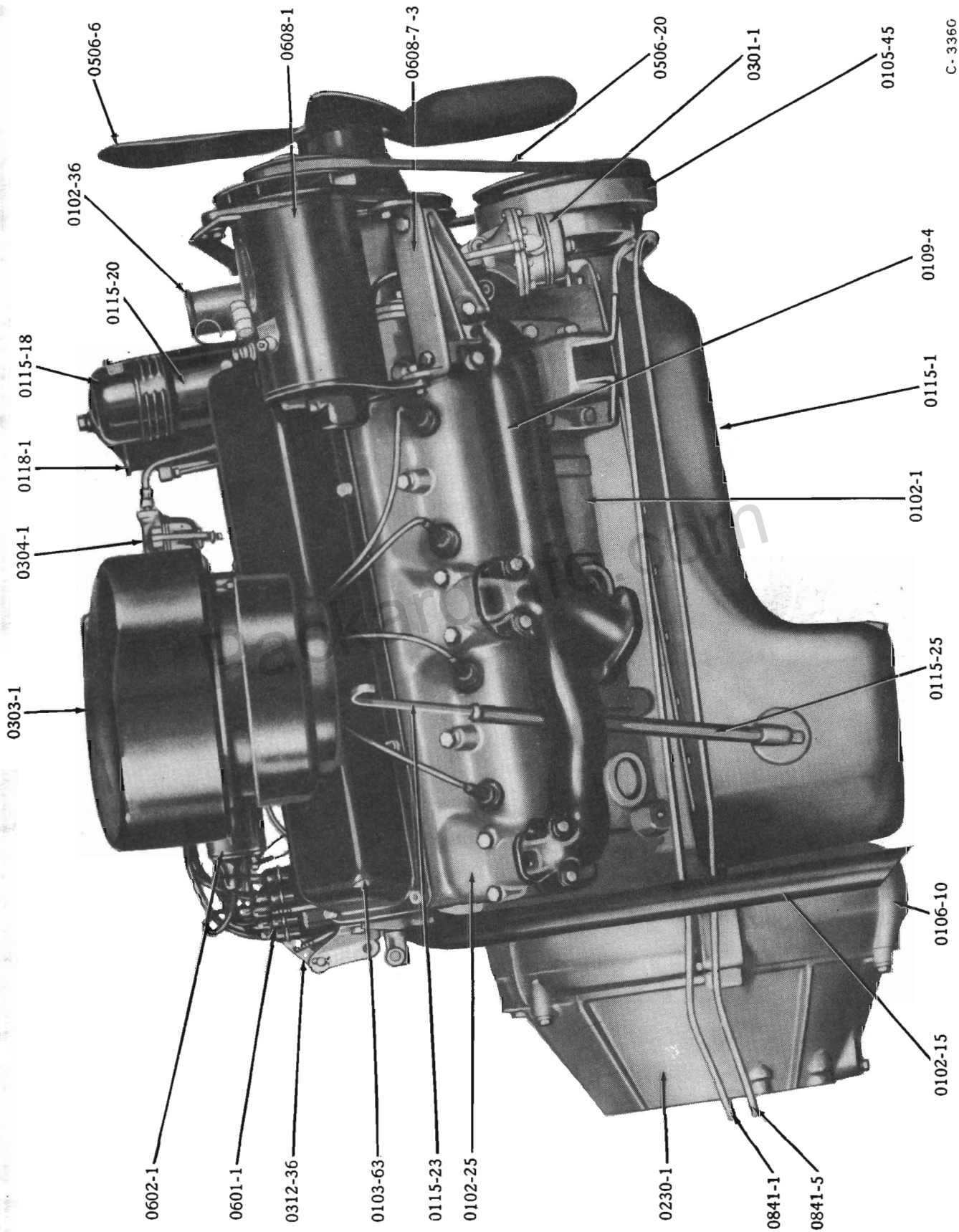

C-3360

ENGINE, RIGHT VIEW - Model 56J

Plate 01-5

ENGINE

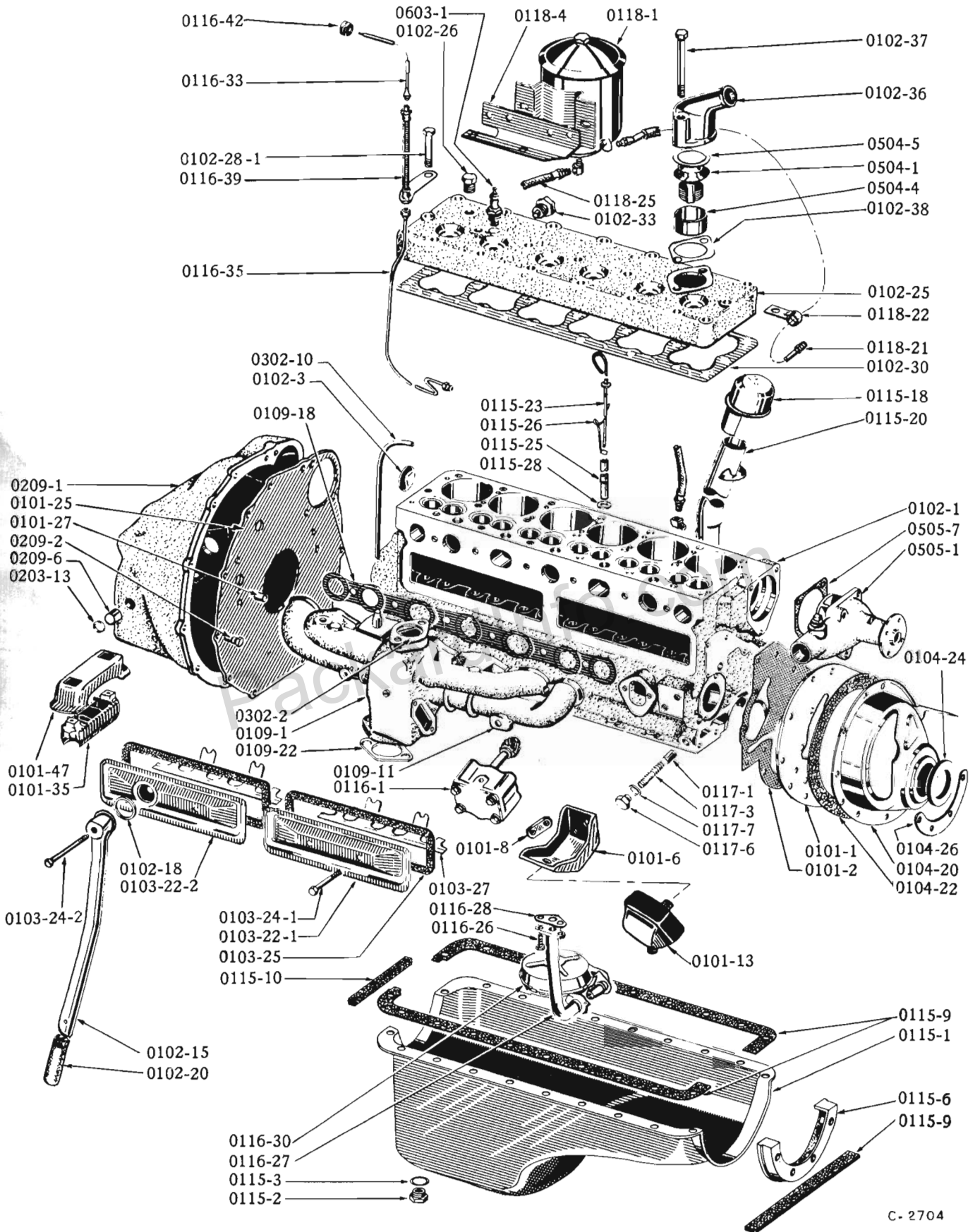

C-2704

ENGINE EXTERNAL PARTS - Models 16G6, 56G, 57G

ENGINE

Plate 01-6

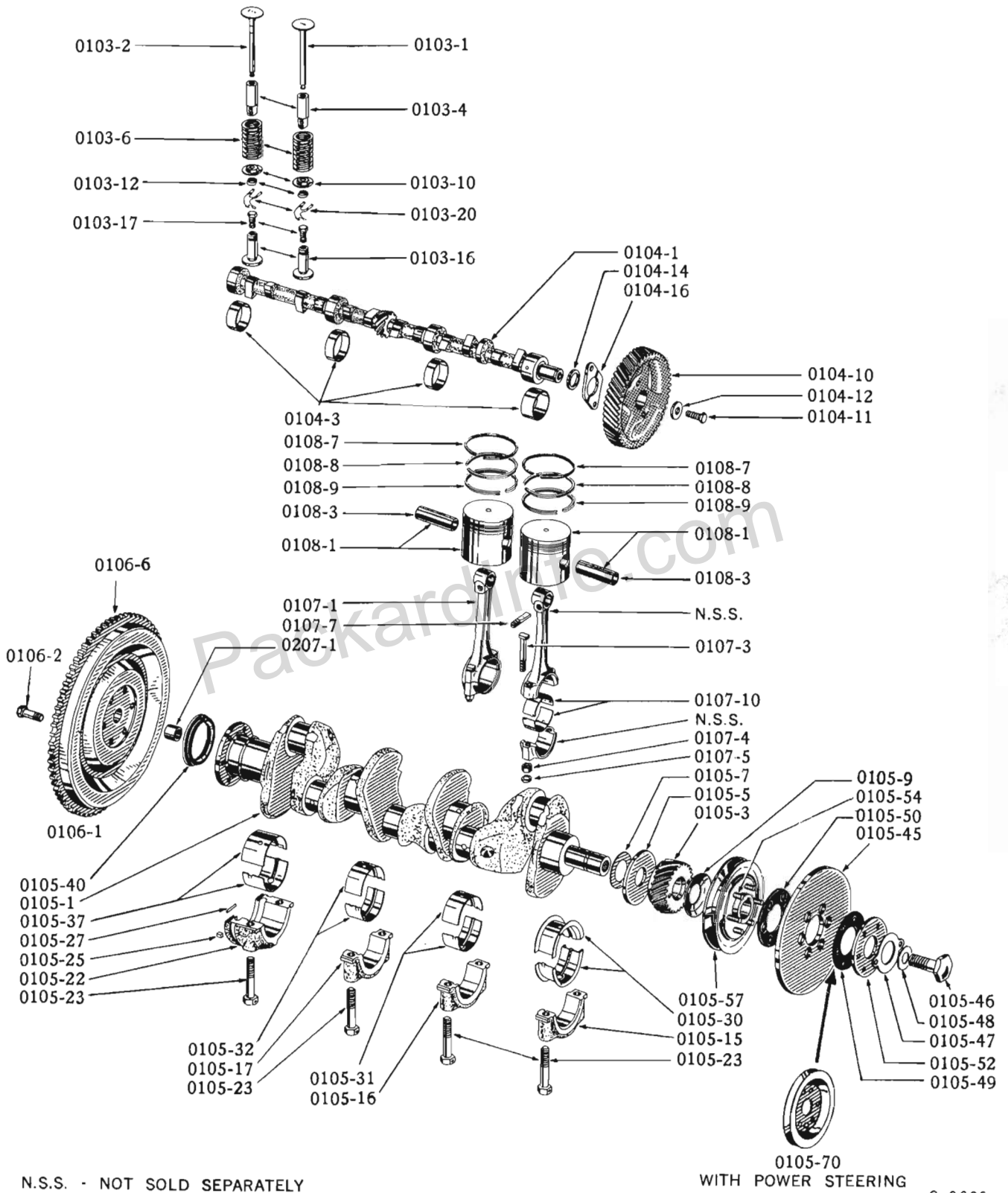

ENGINE, INTERNAL PARTS - Models 16G6, 56G, 57G

Plate 01-7

ENGINE

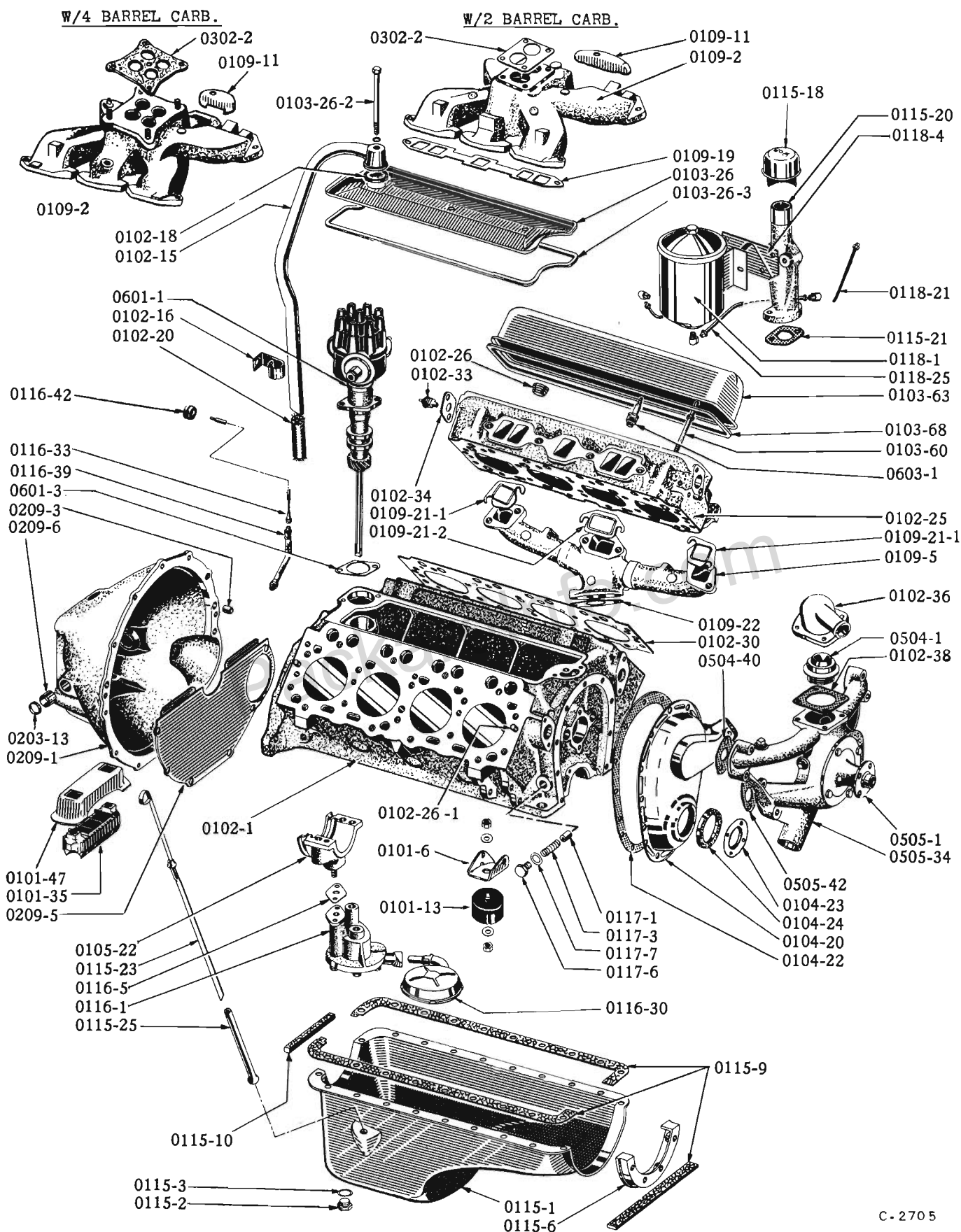

C-2705

ENGINE EXTERNAL PARTS - ALL EIGHTS except 56J

ENGINE

Plate 01-8

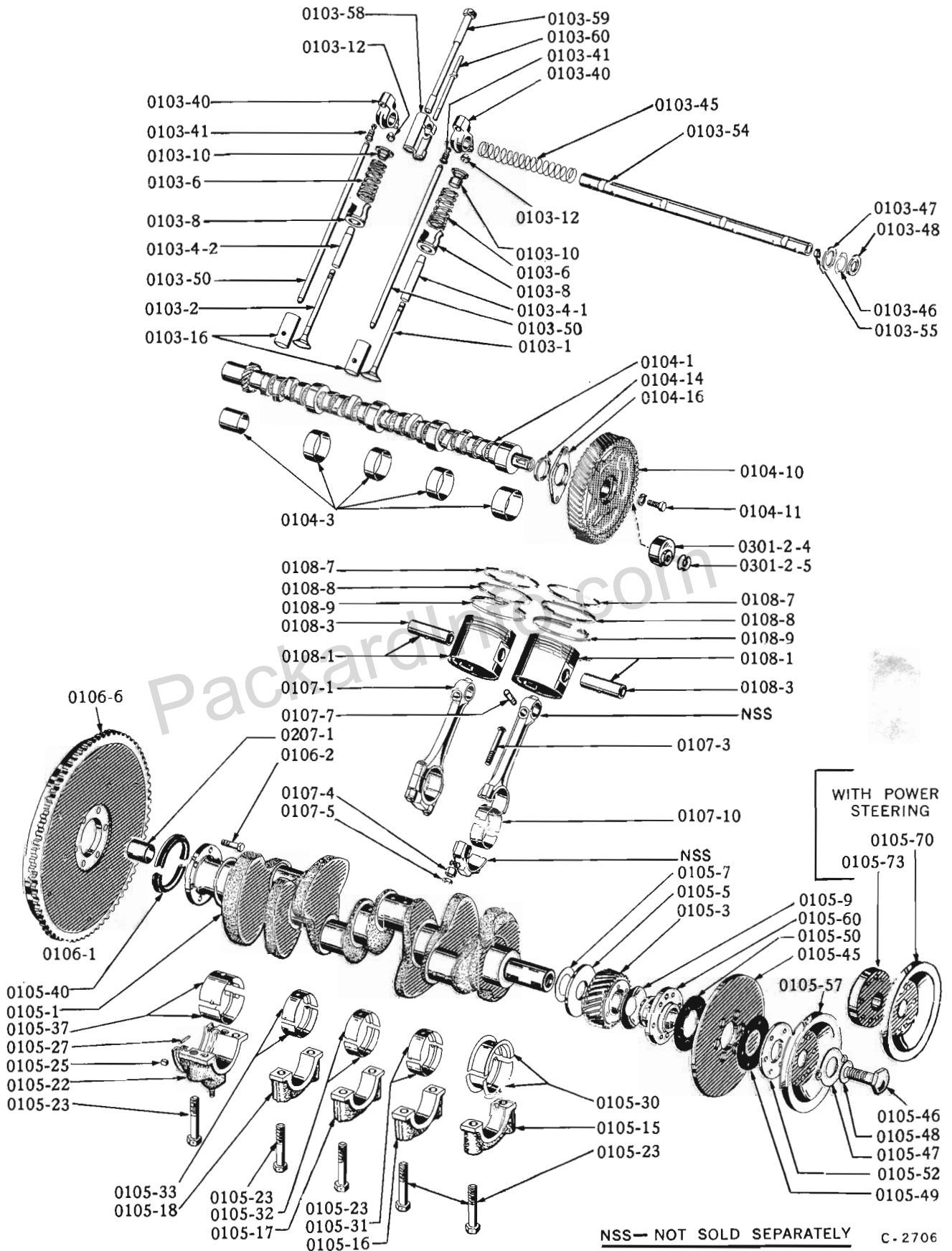

ENGINE, INTERNAL PARTS -ALL EIGHTS except 56J

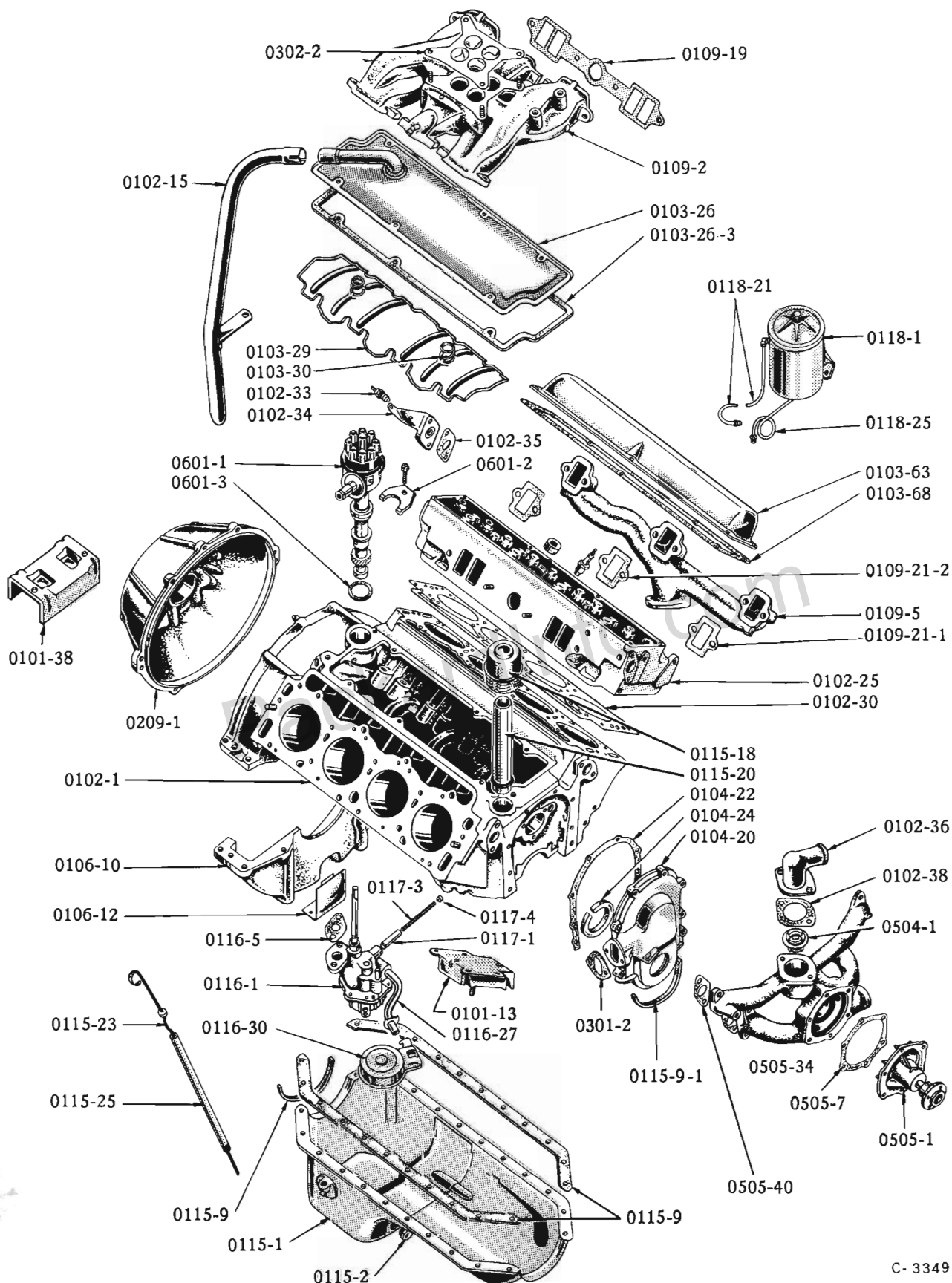

C- 3349

ENGINE EXTERNAL PARTS - Model 56J

ENGINE

Plate 01-10

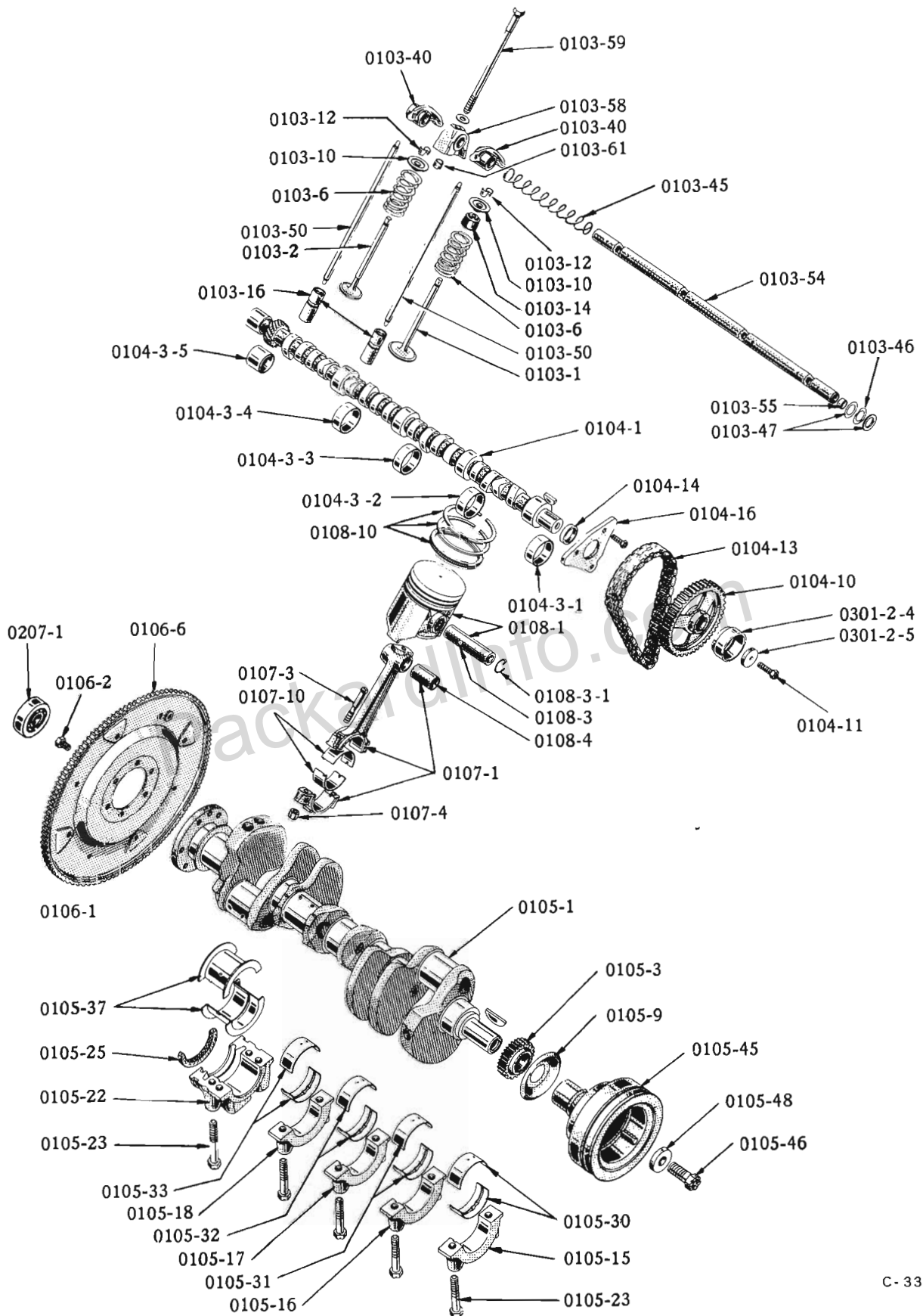

C-3350

ENGINE INTERNAL PARTS - Model 56J

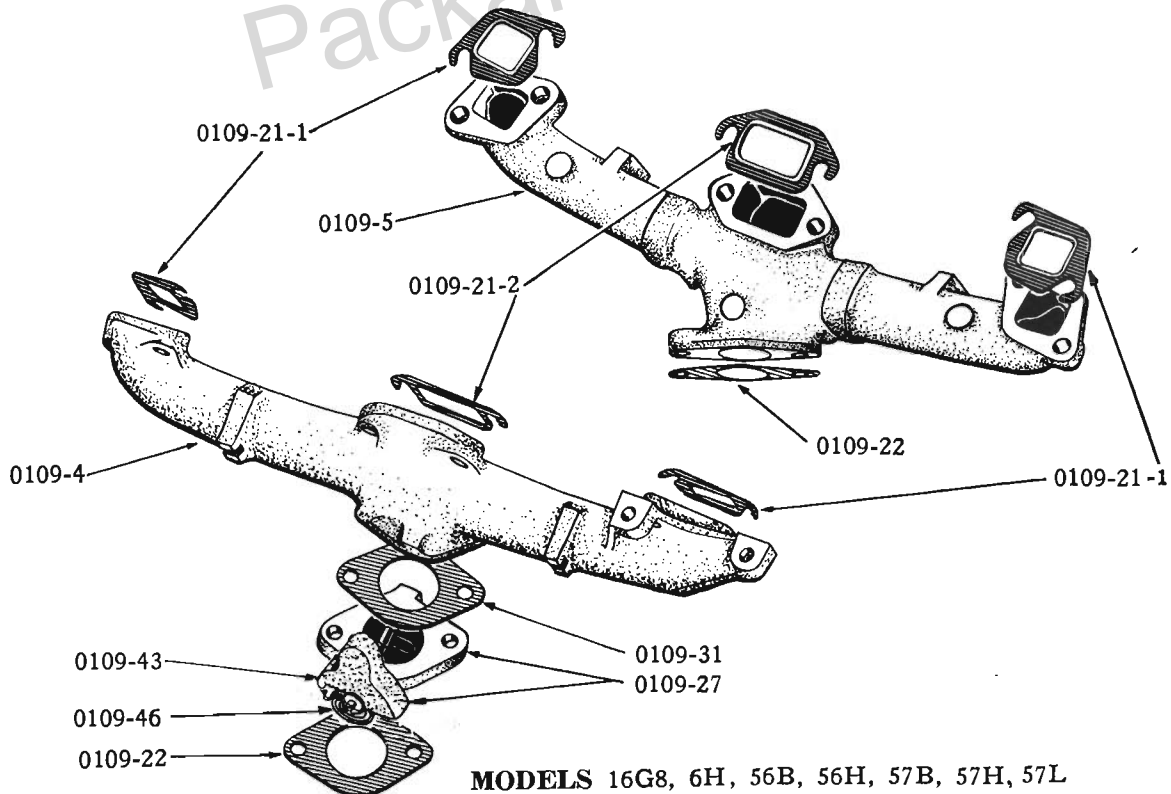
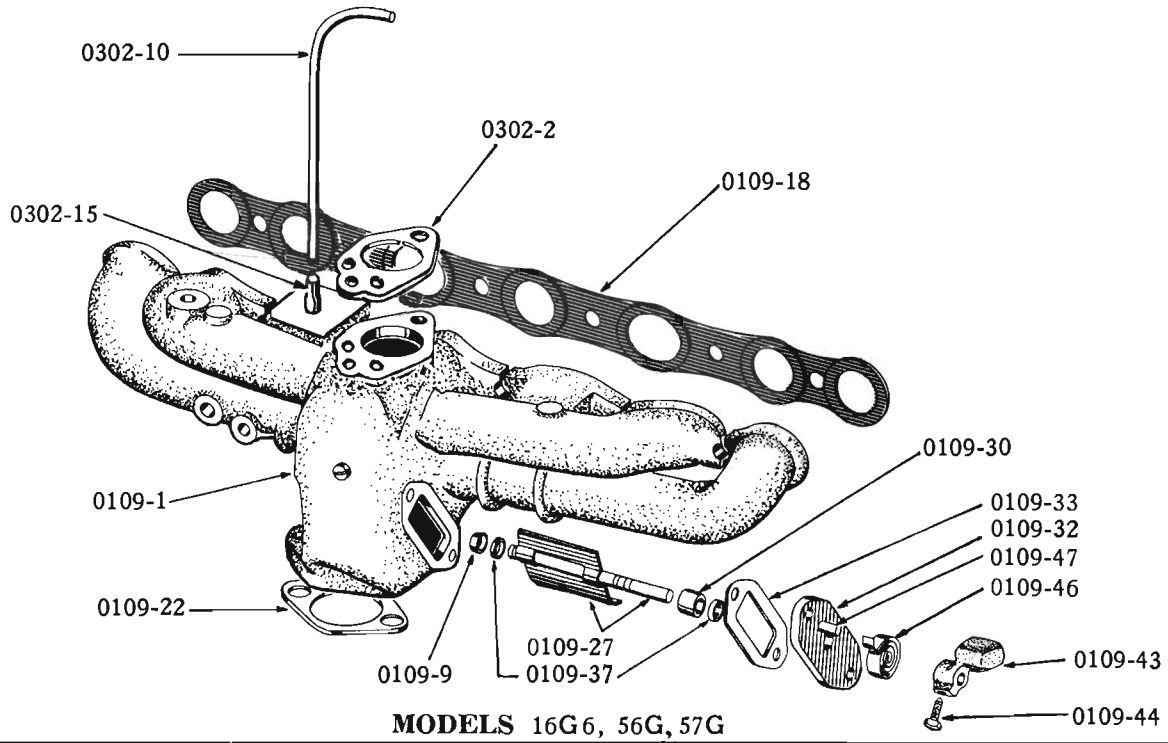

C-2707

MANIFOLDS & HEATER VALVE - ALL MODELS except 56J

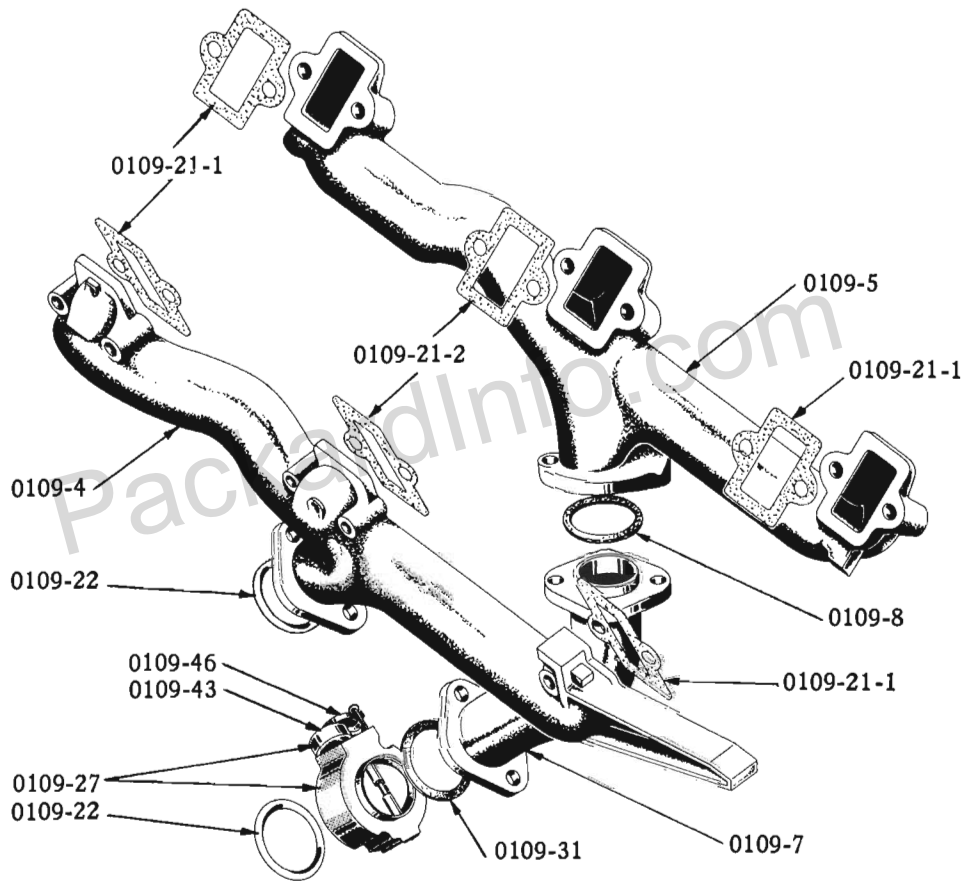

C-3351

MANIFOLDS & HEATER VALVE - Model 56J

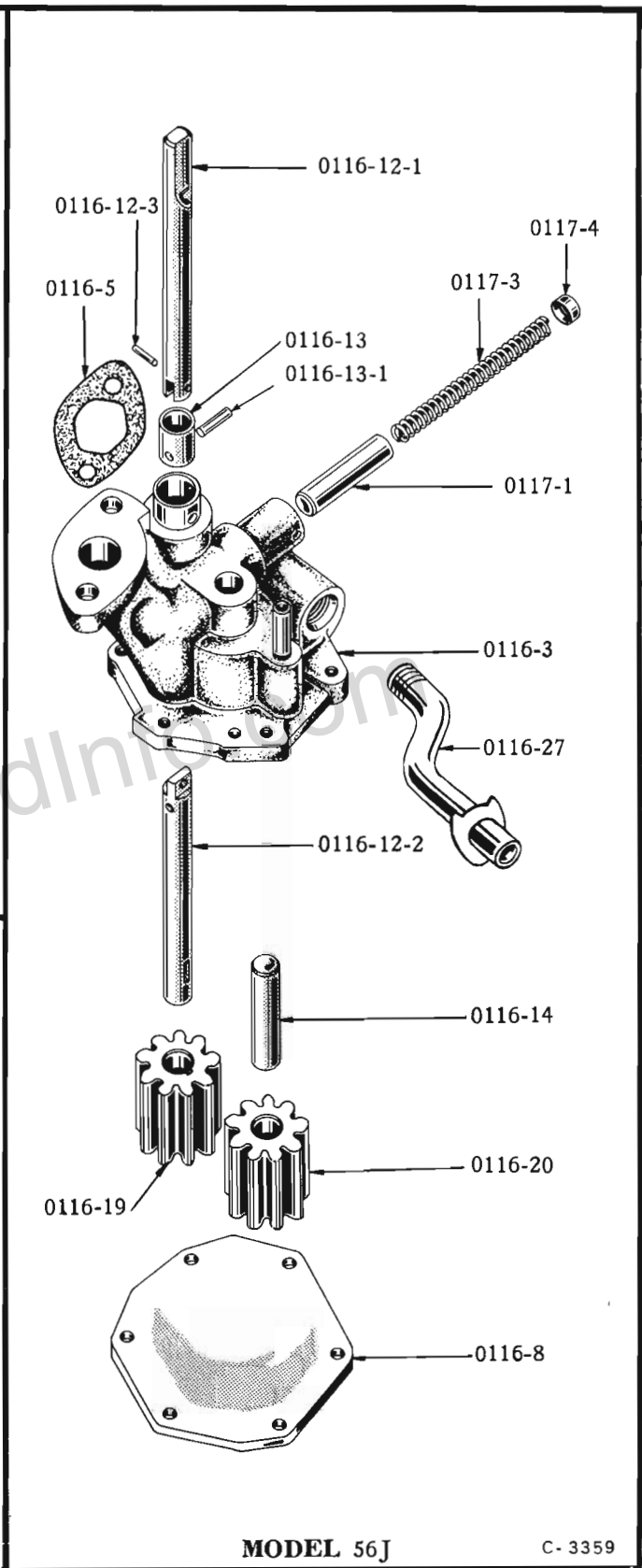
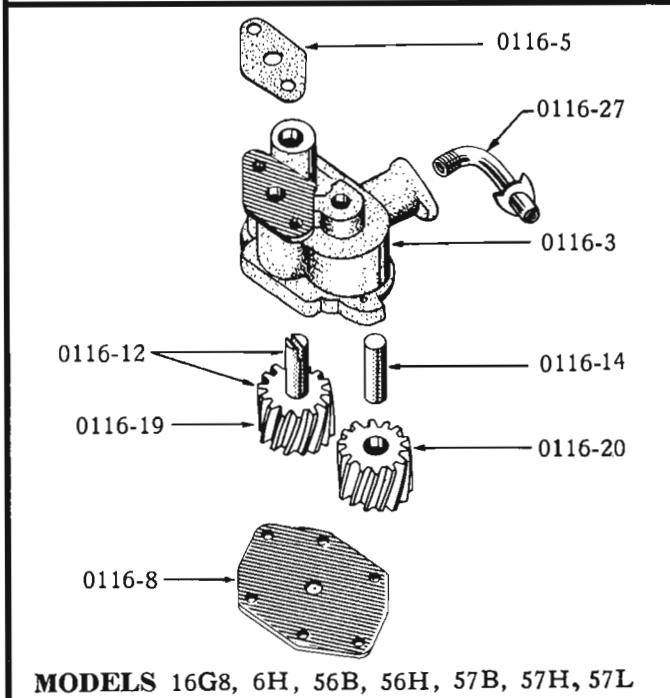
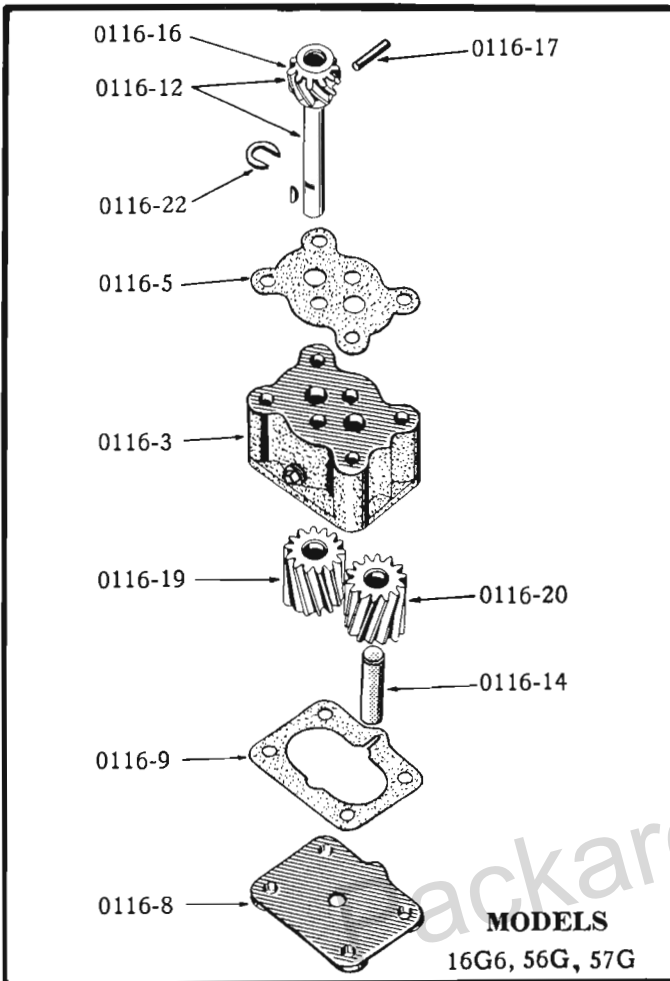

C-3359

OIL PUMPS - All Models

ENGINE

Plate 01-14

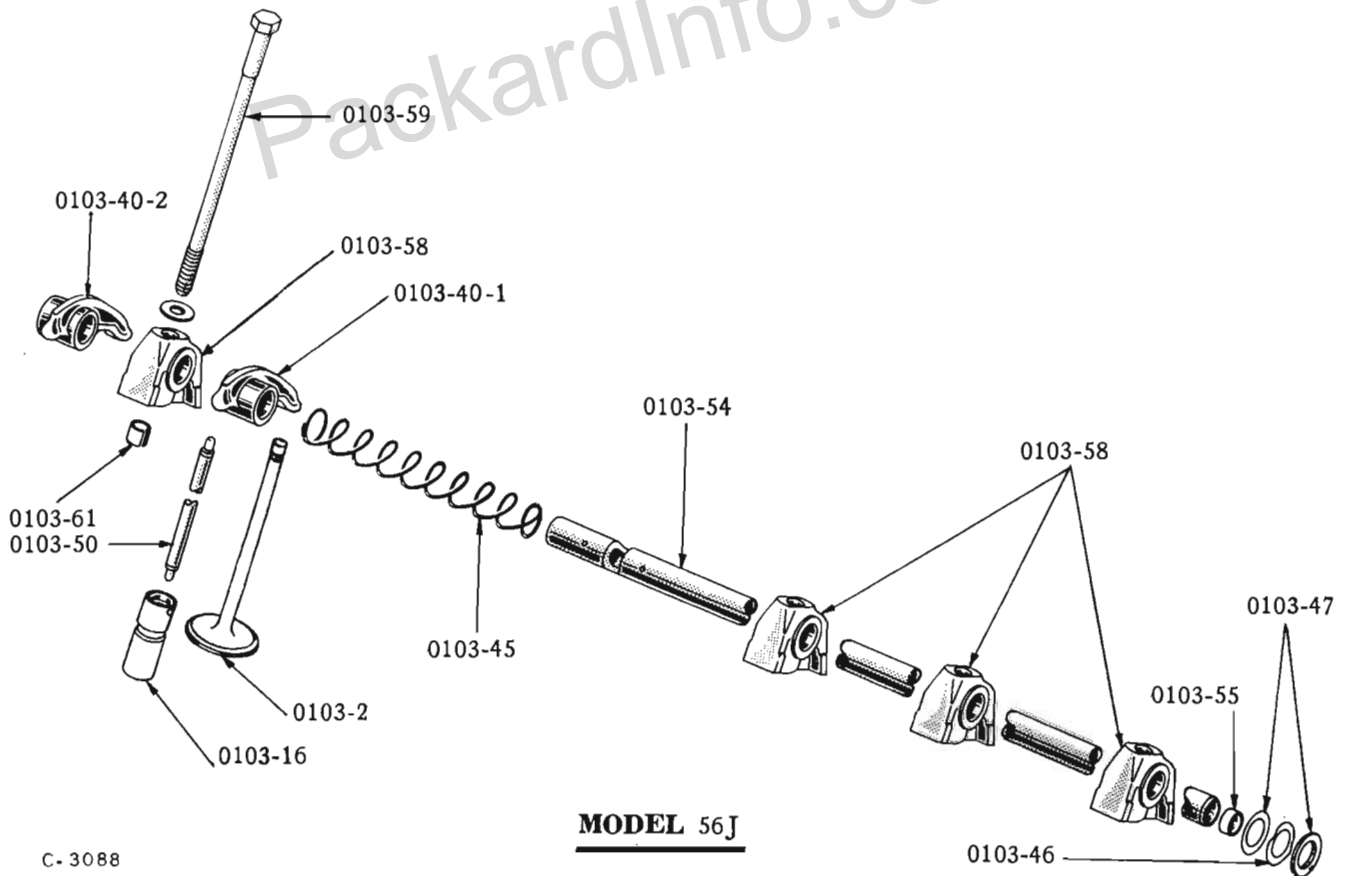
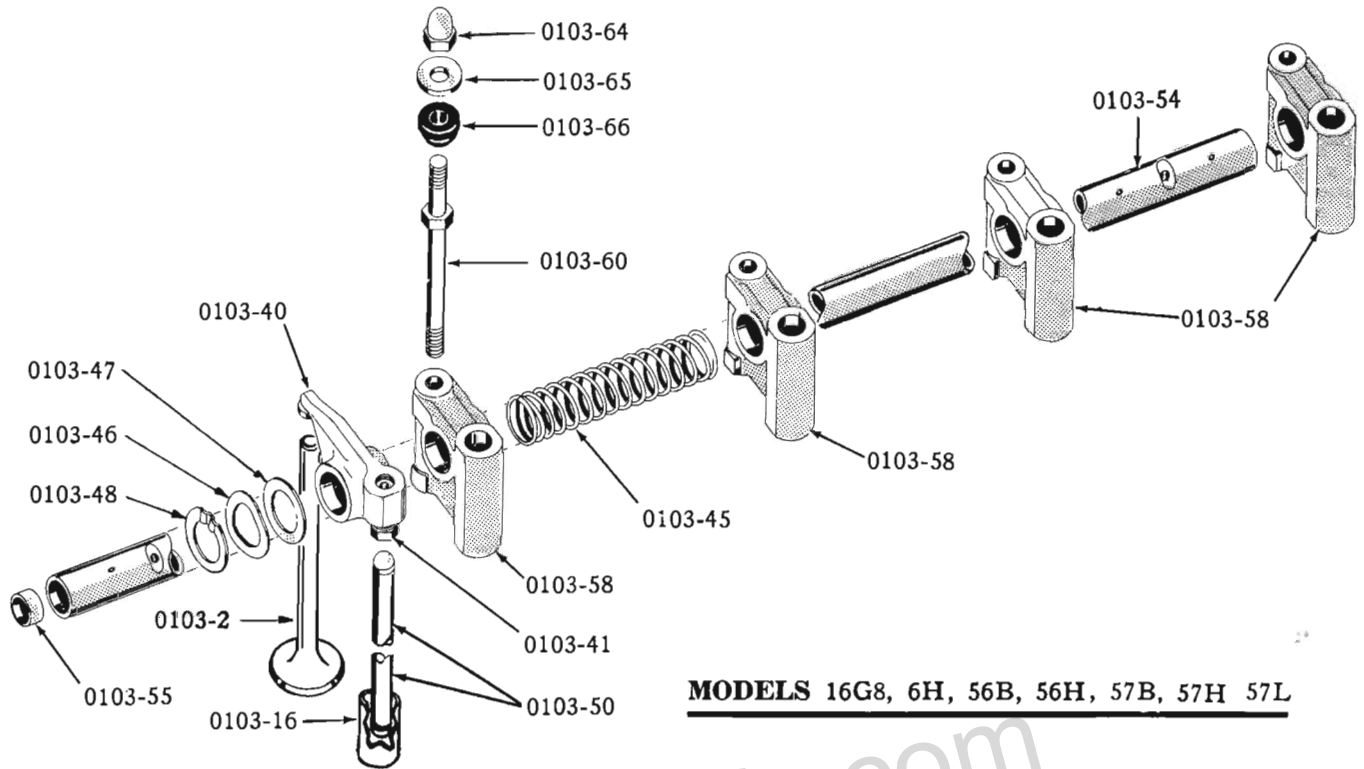

C-3088

ENGINE VALVE ROCKER ARMS, SHAFTS, ETC. - All Eights

ENGINE

ILLUST. NUMBER	PART NUMBER	CHANGE	DESCRIPTION	MODELS	PER CAR
----------------	-------------	--------	-------------	--------	---------

0100- ENGINE ASSEMBLY

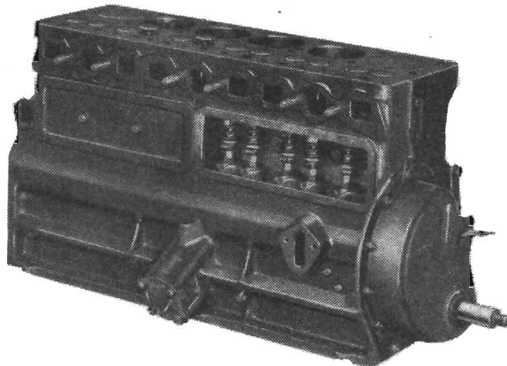

C-2007

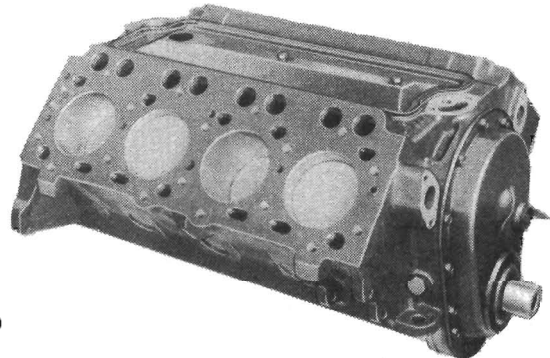

C-3090

STRIPPED ENGINE
MODELS 16G6, 56G, 57G

SHORT BLOCK
MODELS 16G8, 6H, 56B, 56H, 56J, 57B, 57H, 57L

STRIPPED ENGINE:

CONSISTS OF CYLINDER BLOCK, PISTONS, RINGS, CONNECTING RODS, CRANKSHAFT, CAMSHAFT, ALL BEARINGS, TIMING GEARS AND COVER, OIL PRESSURE VALVE, OIL PAN FILLER BLOCK, ENGINE VALVES, VALVE SPRINGS, VALVE COVERS, OIL PUMP, FRONT SUPPORT PLATE AND FLYWHEEL OR CONVERTOR BOLTS.

SHORT BLOCK:

CONSISTS OF CYLINDER BLOCK, PISTONS, RINGS, CONNECTING RODS, CRANKSHAFT, CAMSHAFT, ALL BEARINGS, TIMING GEARS AND COVER, OIL PRESSURE VALVE, OIL PAN FILLER BLOCK, VALVE LIFTER COVER, FUEL PUMP ECCENTRIC AND FLYWHEEL OR CONVERTOR BOLTS.

NOTE - MODEL 56J ENGINES IDENTIFIED BY THE LETTERS XH STAMPED ON THE SERIAL NUMBER PAD ARE EQUIPPED WITH SPECIAL PISTONS, CYLINDER HEAD GASKET SHIMS AND INLET MANIFOLD GASKET SHIMS TO PROVIDE LOW COMPRESSION RATIO FOR EXPORT AND CANADA.

535435	ENGINE STRIPPED	USED WITH ENGINE	16G6, 56G, 57G	1
536086	SHORT BLOCK, ENGINE - NOTE 1.	224"	16G8	1
685059	SHORT BLOCK, ENGINE - NOTE 2.	259"	16G8, 6H, 56B, 57B	1
1539334	SHORT BLOCK, ENGINE -	289"	56B, 56H, 57B, 57H, 57L	1
6484116	SHORT BLOCK, ENGINE - STD.		56J	1
-----	SHORT BLOCK, ENGINE - USED WITH LOW COMP.HEAD (NOT AVAILABLE)		56J	1
537962	GASKET SET, ENGINE OVERHAUL PARTIAL - NOTE A		16G6, 56G, 57G	1
537995	GASKET SET, ENGINE OVERHAUL PARTIAL - NOTE B		16G8, 6H, 56B, 56H, 57B, 57H, 57L	1
458669	GASKET SET, ENGINE OVERHAUL COMPLETE		56J	1

0101- ENGINE MOUNTINGS (Plates 01-1, 2, 3, 4, 5, 7, 9)

FRONT MOUNTINGS

0101-1	533960	PLATE, ENGINE FRONT	16G6, 56G, 57G	1
	G179816	SCREW, TO CYL. BLOCK 5/16" - 18X3/4"	16G6, 56G, 57G	5
	G103320	WASHER, LOCK 5/16"	16G6, 56G, 57G	5
0101-2	533959	GASKET, ENGINE FRONT PLATE	16G6, 56G, 57G	1

- NOTES**
- A . FOR COMPLETE ENGINE OVERHAUL THIS SET MUST BE USED WITH 536557 VALVE GRINDING, 537967 MANIFOLD AND 535997 OIL PAN GASKETS SETS.
 - B . FOR COMPLETE ENGINE OVERHAUL THIS SET MUST BE USED WITH 536265 VALVE GRINDING AND 536559 OIL PAN GASKET SETS.
 - 1 . USED WITH 224 CU. IN. ENGINE ON MODEL 16G8 U. S. A. CANADA
 BEFORE ENGINE NOS. V-331.101 VC-6.201
 - 2 . USED WITH 259 CU. IN. ENGINE ON MODEL 16G8 So. BEND LOS ANGELES CANADA
 ON AND AFTER ENGINE NOS. V-331.101 VL-101 VC-6.201

ENGINE

0101

ILLUST. NUMBER	PART NUMBER	CHANGE	DESCRIPTION	MODELS	PER CAR
0101- ENGINE MOUNTINGS-Cont'd. (Plates 01-1,2,3,4,5,7,9)					
FRONT MOUNTINGS-Cont'd.					
0101-6	536190		BRACKET, RIGHT, FRONT SUPPORT	16G6, 56G, 57G	1
	535745		BRACKET, LEFT, FRONT SUPPORT	16G6, 56G, 57G	1
	681761	●	SCREW, RIGHT, TO CYL. BLOCK 3/8" -16X7/8"	16G6, 56G, 57G	2
	681760	●	SCREW, LEFT, TO CYL. BLOCK 3/8" -16X1 1/16"	16G6, 56G, 57G	2
0101-8	680180		REINFORCEMENT, BRACKET	16G6, 56G, 57G	2
● THESE SCREWS HAVE NYLON INSERTS, WHEN REMOVED IT IS RECOMMENDED NEW ONES BE USED					
0101-6	532404		BRACKET, FRONT SUPPORT (MOUNTED ON BLOCK)	16G8, 6H, 56B, 56H, 57B, 57H, 57L	2
	G181365		BOLT, TO CYL. BLOCK 3/8" -24X1 1/8"	16G8, 6H, 56B, 56H, 57B, 57H, 57L	5
	G181639		BOLT, TO CYL. BLOCK THRU GROUND STRAP 3/8" -24X1 1/4"	16G8, 6H, 56B, 56H, 57B, 57H, 57L	1
	G120369		NUT, HEX. 3/8" -24.	16G8, 6H, 56B, 56H, 57B, 57H, 57L	6
	G120382		WASHER, LOCK 3/8"	16G8, 6H, 56B, 56H, 57B, 57H, 57L	6
0101-9	536202		BRACKET, RIGHT, FRONT SUPPORT - W.F.D.	16G6, 56G, 57G	1
	532399		BRACKET, LEFT, FRONT SUPPORT - W.F.D.	16G6, 56G, 57G	1
0101-9	536223		BRACKET, RIGHT, FRONT SUPPORT - C-K	16G6, 56G, 57G	1
	532379		BRACKET, LEFT, FRONT SUPPORT - C-K	16G6, 56G, 57G	1
0101-9	532400		BRACKET, RIGHT, FRONT SUPPORT -W-F-D-Y-P	16G8, 6H, 56B, 56H, 57B, 57H, 57L	1
	532401		BRACKET, LEFT, FRONT SUPPORT -W-F-D-Y-P	16G8, 6H, 56B, 56H, 57B, 57H, 57L	1
0101-9	532378		BRACKET, RIGHT, FRONT SUPPORT - C-K	16G8, 6H, 56B, 56H, 57B, 57H	1
	532379		BRACKET, LEFT, FRONT SUPPORT - C-K	16G8, 6H, 56B, 56H, 57B, 57H	1
0101-9	1539068		BRACKET, RIGHT, FRONT SUPPORT	56J	1
	1539069		BRACKET, LEFT, FRONT SUPPORT	56J	1
	G181360		BOLT, TO FRAME 3/8" -24X3/4" - W-F-D-Y-P	ALL EXCEPT 56J	4
	G181360		BOLT, TO FRAME 3/8" -24X3/4" - C-K (FOR RIGHT BRACKET)	16G, 6H, 56G, 56B, 57G, 57B, 57H	6
	G451010		NUT, LOCK 3/8" -24.	ALL EXCEPT 56J	*
	----		RIVET, TO FRAME 3/8" X3/4" - C-K (FOR LEFT BRACKET)	16G, 6H, 56G, 56B, 57G, 57B, 57H	6
	----		RIVET, TO FRAME 3/8" X3/4" - K	56H	12
	----		RIVET, TO FRAME 5/16" X7/8" - K	56J	12
0101-13	535743		INSULATOR, FRONT SUPPORT.	16G6, 56G, 57G	2
0101-13	533296		INSULATOR, FRONT SUPPORT.	16G8, 6H, 56B, 56H, 57B, 57H, 57L	2
	G120369		NUT, TO BRACKET 3/8" -24	ALL EXCEPT 56J	4
	G120394		WASHER, PLAIN 3/8"	ALL EXCEPT 56J	2
	G120382		WASHER, LOCK 3/8"	ALL EXCEPT 56J	4
0101-13	1539064		INSULATOR, FRONT SUPPORT	56J	2
	G271506		NUT, TO MTG. BRACKET 7/16" -20	56J	2
	----		WASHER, PLAIN 1/2"	56J	2
	G120383		WASHER, LOCK 7/16"	56J	2
	G179837		SCREW, TO CYL. BLOCK 3/8" -16X3/4"	56J	8
	G120382		WASHER, LOCK 3/8"	56J	8

NOTE { * - USE AS REQUIRED

ILLUST. NUMBER	PART NUMBER	CHANGE	DESCRIPTION	MODELS	PER CAR
----------------	-------------	--------	-------------	--------	---------

0101- ENGINE MOUNTINGS-Cont'd. (Plates 01-1, 2, 3, 4, 5, 7, 9)

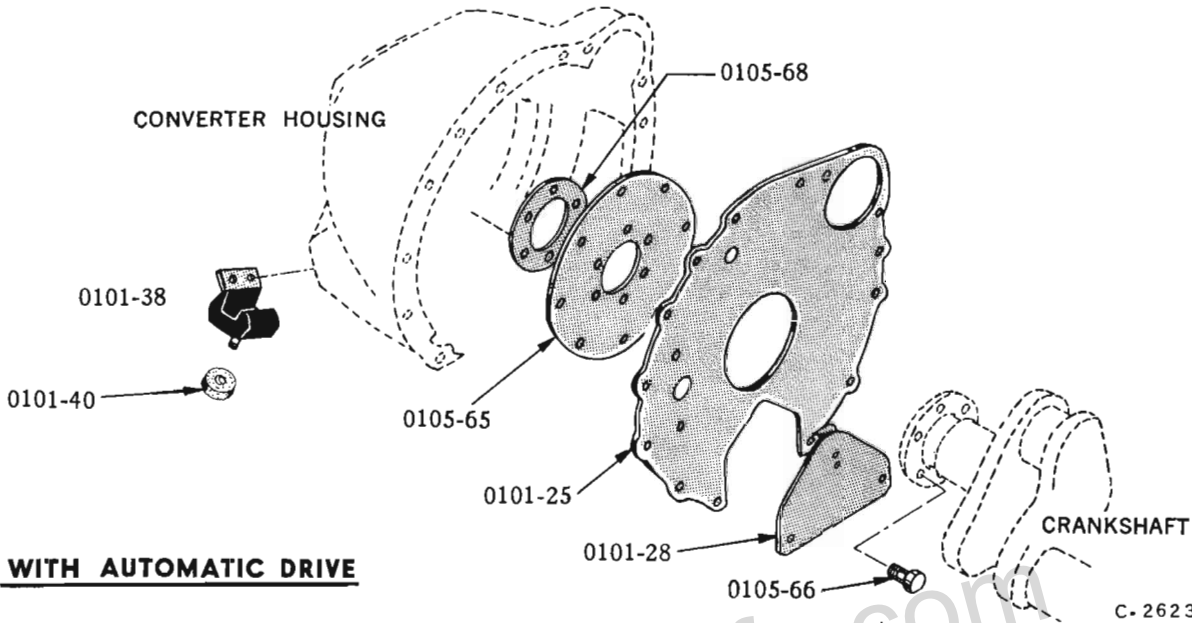

C-2623

REAR MOUNTINGS

0101-25	534000	PLATE, ENGINE REAR - W/ST. AND OD	16G6, 56G, 57G	1
0101-25	533484	PLATE, ENGINE REAR - W/AD	16G6, 56G, 57G	1
0101-27	510165	DOWEL, PIN 3/8" X 5/8"	16G6, 56G, 57G	2
	G179837	SCREW, TO CYL. BLOCK 3/8" - 16X3/4"	16G6, 56G, 57G	4
	G138489	WASHER, SHAKEPROOF 3/8"	16G6, 56G, 57G	4
0101-28	527388	COVER AND CLIP, ENGINE REAR PLATE - WITH AD	16G6, 56G, 57G	1
	----	BOLT, TO PLATE 1/4" - 28X3/4"	16G6, 56G, 57G	2
	G120367	NUT, HEX. 1/4" - 28	16G6, 56G, 57G	2
	G120392	WASHER, PLAIN 1/4"	16G6, 56G, 57G	1
	G120380	WASHER, LOCK 1/4"	16G6, 56G, 57G	2
0101-35	533330	INSULATOR, REAR SUPPORT } w/ST. AND OD.	16G6, 56G, 57G	1
0101-35	536314	INSULATOR, REAR SUPPORT }	16G8, 6H.	1
0101-35	6489495	INSULATOR, REAR SUPPORT }	56B, 56H.	1
0101-35	1542879	INSULATOR, REAR SUPPORT }	57B, 57H, 57L.	1
	G179891	SCREW, TO CLUTCH HOUSING 1/2" - 13X2 1/2"	16G, 6H, 56G, 57G	2
	G135629	WASHER, SHAKEPROOF 1/2"	16G, 6H, 56G, 57G	2
	G120340	SCREW, TO CLUTCH HOUSING 1/2" - 13X7/8"	56B, 56H, 57B, 57H, 57L.	2
	----	WASHER, LOCK 1/2"	56B, 56H, 57B, 57H, 57L.	2
	----	NUT, LOCK, TO CROSS MEMBER 3/8" - 14.	56B, 56H, 57B, 57H, 57L.	2
0101-38	526471	INSULATOR, RIGHT, REAR SUPPORT } w/AD.	16G, 6H	1
	532425	INSULATOR, LEFT, REAR SUPPORT }	16G, 6H	1
0101-38	1539942	INSULATOR, RIGHT, REAR SUPPORT } w/AD.	56G, 56B, 56H, 57G, 57B, 57H, 57L.	1
	1539943	INSULATOR, LEFT, REAR SUPPORT }	56G, 56B, 56H, 57G, 57B, 57H, 57L.	1
	G179856	SCREW, TO CONVERTER HOUSING 7/16" - 14X3/4"	16G, 6H	4
	G179859	SCREW, TO CONVERTER HOUSING 7/16" - 14X1 1/8"	56G, 56B, 56H, 57G, 57B, 57H, 57L.	4
	G120383	WASHER, LOCK 7/16"	ALL EXCEPT 56J	4
	G271506	NUT, TO FRAME 7/16" - 20	ALL EXCEPT 56J	2
	41X359	WASHER, PLAIN 7/16"	ALL EXCEPT 56J	2
	G120383	WASHER, LOCK 7/16"	ALL EXCEPT 56J	2
0101-40	532427	SPACER, LEFT SIDE	ALL EXCEPT 56J, 57L	1
0101-40	532427	SPACER, LEFT SIDE - LHC	57L	1
0101-40	532427	SPACER, RIGHT SIDE - RHC	57L	1

ENGINE

0102

ILLUST. NUMBER	PART NUMBER	CHANGE	DESCRIPTION	MODELS	PER CAR
0101- ENGINE MOUNTINGS-Cont'd. (Plates 01-1,2,3,4,5,7,9)					
REAR MOUNTINGS-Cont'd.					
0101-38	6489495		INSULATOR, REAR SUPPORT	56J	1
	G442828		NUT, TO CROSS MEMBER 3/8" -24.	56J	2
	G106340		SCREW, TO TRANS. CASE 1/2" -13X7/8"	56J	2
	----		WASHER, LOCK 1/2"	56J	2
0101-47	532426		CAGE, REAR SUPPORT INSULATOR - W/ST. AND OD.	16G,6H,56G,57G	1
	G181365		BOLT, TO FRAME 3/8" -24X1 1/8"	16G,6H,56G,57G	2
	G120369		NUT, HEX. 3/8" -24.	16G,6H,56G,57G	2
	----		WASHER, PLAIN 7/16"	16G6,56G,57G.	2
	----		WASHER, LOCK 3/8"	16G,6H,56G,57G.	2
0102- CYLINDER BLOCK, HEAD AND GASKET					
(PLATES 01-1, 2, 3, 4, 5, 7, 9)					
CYLINDER BLOCK			USED WITH ENGINE		
	535429		CYLINDER BLOCK ASSY.	16G6,56G,57G.	1
	536200		CYLINDER BLOCK ASSY. - NOTE 1 } FITTED WITH 224"	16G8	1
	684531		CYLINDER BLOCK ASSY. - NOTE 2 } PISTONS, 259"	16G8,6H,56B,57B	1
	1539333		CYLINDER BLOCK ASSY.	56B,56H,57B,57H,57L	1
	6484556		CYLINDER BLOCK ASSY. - STD. } RINGS	56J	1
	▲ -----		CYLINDER BLOCK ASSY. -(FOR LOW COMP. HEAD)	56J	1
0102-1	-----		CYLINDER BLOCK (USE 535429)	16G6,56G,57G	1
0102-3	172631		PLUG, WATER JACKET 1 1/2"	16G6,56G,57G.	1
	194166		PLUG, WATER JACKET 1 7/8"	16G6,56G,57G.	4
	G103879		PLUG, WATER JACKET DRAIN 3/8"	16G6,56G,57G.	1
	G444734		PLUG, OIL DISTRIBUTOR LINE END 1/4"	16G6,56G,57G.	4
	G103877		PLUG, CRANKSHAFT BEARING OIL HOLE 1/8"	16G6,56G,57G.	4
	194665		PLUG, CAMSHAFT REAR BEARING HOLE 1 3/4"	16G6,56G,57G.	1
	106028		PLUG, OIL FILLER HOLE	16G6,56G,57G.	1
0102-1	-----		CYLINDER BLOCK (USE 536200, 684531 OR 1539333).	16G8,6H,56B,56H,57B,57H,57L	1
	172631		PLUG, WATER JACKET 1 1/2"	16G8,6H,56B,56H,57B,57H,57L	6
	G444740		PLUG, WATER JACKET DRAIN 3/8"	16G8,6H,56B,56H,57B,57H,57L	2
	G444866		PLUG, OIL DISTRIBUTOR LINE END 3/8"	16G8,6H,56B,56H,57B,57H,57L	4
	530160		PLUG, OIL DISTRIBUTOR LINE END 1 1/4"	16G8,6H,56B,56H,57B,57H,57L	1
	1539038		PLUG, CAMSHAFT REAR BEARING HOLE 1 1/2"	16G8,6H,56B,56H,57B,57H,57L	1
	G444728		PLUG, CAMSHAFT REAR BEARING OIL LINE 1/8"	16G8,6H,56B,57H,57B,57H,57L	1
	G444728		PLUG, DIST. SHAFT OIL LINE 1/8" (SQ. HEAD)	16G8,6H,56B,56H,57B,57H,57L	1
	G103883		PLUG, DIST. SHAFT OIL LINE 1/8" (SLTD. HEAD)	16G8,6H,56B,56H,57B,57H,57L	1
0102-1	-----		CYLINDER BLOCK (USE 6484556).	56J	1
	427204		PLUG, WATER JACKET	56J	6
	G127950		PLUG, WATER JACKET DRAIN 1/8"	56J	2
	-----		PLUG, OIL PASSAGE - 1/4" SQ. HEAD	56J	1
	G106517		PLUG, OIL GALLERY LEFT REAR OUTER 1 1/8"	56J	1
	G126045		PLUG, OIL GALLERY REAR 3/8"	56J	2
	G103877		PLUG, VACUM HOLE 1/8"	56J	1
	G103897		PLUG, CAMSHAFT REAR BEARING HOLE 1 3/4"	56J	1
	527358		DRAIN COCK, CYLINDER BLOCK } SERVICE ONLY	16G6,56G,57G	1
	680171		DRAIN COCK, CYLINDER BLOCK }	16G8,6H,56B,56H,57B,57H,57L	1
	G119931		BUSHING, REDUCING	16G8,6H,56B,56H,57B,57H,57L	1
	1258X2		HOSE, DRAIN COCK } SERVICE ONLY	16G6,56G,57G	1
	1258X3		HOSE, DRAIN COCK }	16G8,6H,56B,56H,57B,57H,57L	1

NOTES {

- ▲ - NOT AVAILABLE
- 1 - USED WITH 224 CU. IN. ENGINE ON MODEL 16G8 U.S.A. | CANADA
- BEFORE ENGINE NOS. V-331,101 | VC-6,201
- 2 - USED WITH 259 CU. IN. ENGINE ON MODEL 16G8 So.BEND | LOS ANGELES | CANADA
- ON AND AFTER ENGINE NOS. V-331,101 | VL-101 | VC-6,201

ENGINE

ILLUST. NUMBER	PART NUMBER	CHANGE	DESCRIPTION	MODELS	PER CAR
0102- CYLINDER BLOCK, HEAD AND GASKET-Cont'd.					
(plates 01-1, 2, 3, 4, 5, 7, 9)					
CYLINDER BLOCK-Cont'd.					
0102-15	519859		TUBE, BREATHER	16G6, 56G, 57G	1
0102-15	681940		TUBE, BREATHER	16G8, 6H, 56B, 56H, 57B, 57H, 57L	1
0102-15	1539732		TUBE, BREATHER	56J	1
0102-24-2	G186273		SCREW, THRU VALVE COVER 5/16" - 18X4 1/4"	16G6, 56G, 57G	1
0103-26-2	530320		SCREW, TO VALVE LIFTER COVER 5/16" - 18X5 1/16"	16G8, 6H, 56B, 56H, 57B, 57H, 57L	1
	6240743		CLAMP, TO VALVE LIFTER COVER TUBE	56J.	1
0102-16	683463		BRACKET, BREATHER TUBE	16G8, 6H, 56B, 56H, 57B, 57H, 57L	1
0102-18	194194		GASKET, BREATHER TUBE - CORK (INCL. IN 536557 SET)	16G6, 56G, 57G	1
0102-18	510550		GASKET, BREATHER TUBE - CORK	16G8, 6H, 56B, 56H, 57B, 57H, 57L	1
0102-20	530471		PACK, BREATHER TUBE FILTER	16G6, 56G, 57G	1
	-----		COTTER, 1/16" X 1/2"	16G6, 56G, 57G	1
CYLINDER HEAD					
0102-25	536180		HEAD, CYLINDER (7.5 TO 1 RATIO)	16G6, 56G, 57G	1
0102-25	536603		HEAD, CYLINDER (7 TO 1 RATIO) SPECIAL EXPORT	16G6, 56G, 57G	1
0102-26	G440740		PLUG, CORE 3/8"	16G6, 56G, 57G	1
0102-28-1	194459		SCREW, TO CYL. BLOCK 7/16" - 14X2 5/16" (LESS POWER STEER.)	16G6, 56G, 57G	19
0102-28-1	194459		SCREW, TO CYL. BLOCK 7/16" - 14X2 5/16" (WITH POWER STEER.)	16G6, 56G, 57G	17
	520498		SCREW, TO BLOCK THRU CABLES BRKT. 7/16" - 14X2 11/16"	16G6, 56G, 57G	1
	533720		STUD, TO CYL. BLOCK 7/16" - 14-20X3 9/16" (WITH POWER STEER.)	16G6, 56G, 57G	2
	G120395		WASHER, PLAIN 7/16" (FOR 520498)	16G6, 56G, 57G	1
0102-25	536097		HEAD, CYLINDER (7.5 TO 1 RATIO).	16G8, 6H, 56B, 56H, 57B, 57H	2
0102-25	536790		HEAD, CYLINDER (7 TO 1 RATIO) SPECIAL EXPORT	16G8, 6H, 56B, 56H, 57B, 57H	2
0102-25	537571		HEAD, CYLINDER (8 TO 1 RATIO).	16G8, 6H, 56B, 56H, 57B, 57H	2
0102-25	536097		HEAD, CYLINDER-7.5 TO RATIO-STD. } w/SUPERCHARGER	57H, 57L.	1
0102-25	536790		HEAD, CYLINDER-7-1 TO RATIO-EXPORT } w/SUPERCHARGER	57H, 57L.	1
	6444728		PLUG, OIL LINE 1/8"	16G8, 6H, 56B, 56H, 57B, 57H, 57L	2
0102-26-1	527831		DOWEL, PIN .434X21/32"	16G8, 6H, 56B, 56H, 57B, 57H, 57L	4
	527834		SCREW, TO CYL. BLOCK 7/16" - 14X3 9/16" (LESS POWER STEER.)	16G8, 6H, 56B, 56H, 57B, 57H, 57L	18
	527834		SCREW, TO CYL. BLOCK 7/16" - 14X3 9/16" (WITH POWER STEER.)	16G8, 6H, 56B, 56H, 57B, 57H, 57L	16
	527835		SCREW, TO CYL. BLOCK 7/16" - 14X4 1/4"	16G8, 6H, 56B, 56H, 57B, 57H, 57L	10
0103-59	527718		SCREW, TO BLOCK THRU ROCKER ARM BRKT. 7/16" - 14X6 9/16"	16G8, 6H, 56B, 56H, 57B, 57H, 57L	8
	532446		STUD, TO CYL. BLOCK 7/16" - 14-20X4 15/16" (WITH POWER STEER.)	16G8, 6H, 56B, 56H, 57B, 57H, 57L	2
	1539067		WASHER, PLAIN 7/16" (FOR 527718)	16G8, 6H, 56B, 56H, 57B, 57H, 57L	8
0102-25	6480407		HEAD, CYLINDER	56J.	2
	G103876		PLUG, CORE HOLE 1"	56J.	2
	G444687		PLUG, OIL LINE 1/8"	56J.	1
	427142		DOWEL, PIN 1/2" X13/16"	56J.	4
	440137		SCREW, TO CYL. BLOCK 7/16" - 14X3 5/8"	56J.	12
	440139		SCREW, TO CYL. BLOCK 7/16" - 14X5 7/16"	56J.	10
0103-59	440140		SCREW, TO CYL. BLOCK 7/16" - 14X7 1/4"	56J.	8
	440869		WASHER, PLAIN 7/16"	56J.	30
0102-30	534598		GASKET, CYLINDER HEAD (INCL. IN 536557 SET)	16G6, 56G, 57G	1
0102-30	535982		GASKET, CYLINDER HEAD (INCL. IN 536265 SET)	16G8, 6H, 56B, 56H, 57B, 57H, 57L	2
0102-30	440469		GASKET, CYLINDER HEAD (INCL. IN 458669-70 SETS)	56J.	2
	6480755		SHIM, CYL. HEAD GASKET (USED WITH LOW COMPARISON CYLINDER HEAD - EXPORT AND CANADA)	56J.	2

ENGINE

0102

ILLUST. NUMBER	PART NUMBER	CHANGE	DESCRIPTION	MODELS	PER CAR
0102- CYLINDER BLOCK, HEAD AND GASKET-Cont'd.					
(Plates 01-1, 2, 3, 4, 5, 7, 9)					
CYLINDER HEAD-Cont'd.					
	536557		GASKET SET, VALVE GRINDING - CONSISTS OF THE FOLLOWING GASKETS: . . .	16G6, 56G, 57G	1
			1- 534598 CYLINDER HEAD	1- 194660 WATER OUTLET	
			2- 536554 VALVE COVER	1- 194658 THERMOSTAT	
			4- G114622 VALVE COVER SCREW	1- 194194 BREATHER TUBE	
	536265		GASKET SET, VALVE GRINDING - CONSISTS OF THE FOLLOWING GASKETS: . . .	16G8, 6H, 56B, 56H, 57B, 57H, 57L	1
			2- 535982 CYLINDER HEAD	1- 536183 HEATER VALVE	
			2- 536555 ROCKER ARM COVER	2- 527240 WATER MANIFOLD-UPPER	
			2- 530266 INLET MANIFOLD	2- 527856 WATER MANIFOLD-LOWER	
			4- 536003 EXH. MANIFOLD-END	1- 527284 WATER OUTLET	
			2- 536004 EXH. MANIFOLD-CENTER	16- 536264 VALVE OIL DEFLECTOR	
			2- 536183 EXH. PIPE FLANGE		
	458670		GASKET SET, VALVE GRINDING - CONSISTS OF THE FOLLOWING GASKETS: . . .	56J	1
			2- 440469 CYLINDER HEAD	2- 6480211 INLET MANIFOLD	
			1- 458668 ROCKER ARM COVER SET	1- 440363 VALVE LIFTER COVER	
			4- 446742 EXH. MANIFOLD-END	4- 440333 WATER MANIFOLD	
			2- 446743 EXH. MANIFOLD-CENTER		
	527304		COVER, RIGHT CYLINDER HEAD REAR END (NOT USED AIR CONDITIONER)	16G8, 6H, 56B, 56H, 57B, 57H, 57L	1
	440336		COVER, RIGHT CYLINDER HEAD REAR END - w/OD.	56J	1
0102-31	6480544		COVER, RIGHT CYLINDER HEAD REAR END - w/AD. (ILLUST. PLATE 03-12)	56J	1
	-----		SCREW, TO HEAD 5/16" - 18X5/8"	16G8, 6H, 56B, 56H, 57B, 57H, 57L	2
	G120214		WASHER, LOCK 5/16"	16G8, 6H, 56B, 56H, 57B, 57H, 57L	2
	G100133		SCREW, TO HEAD 3/8" - 16X3/4"	56J	2
	G120382		WASHER, LOCK 3/8"	56J	2
	G445686		PLUG, PIPE 3/8"	56J	1
	527240		GASKET, RIGHT CYL. HEAD REAR END COVER	16G8, 6H, 56B, 56H, 57B, 57H, 57L	1
	440333		GASKET, RIGHT CYL. HEAD REAR END COVER	56J	1
	-----		RADIMETER OR HEAT INDICATOR (DASH UNIT) SEE GROUP 1714		
0102-33	532579		GAGE, WATER TEMPERATURE	16G, 6H	1
0102-33	1539876		GAGE, WATER TEMPERATURE	56G, 56B, 56H, 56J, 57G, 57B, 57H	1
0102-33	1543609		GAGE, WATER TEMPERATURE	57L	1
	G120614		NUT, TERMINAL No. 10-32.	ALL MODELS	1
	G138479		WASHER, LOCK No. 10.	ALL MODELS	1
0102-34	529456		ADAPTER, WATER TEMPERATURE GAGE	16G8, 6H, 56B, 56H, 57B, 57H	1
	6480543		ADAPTER, WATER TEMPERATURE GAGE - w/OD.	56J	1
0102-34	6480546		ADAPTER, WATER TEMPERATURE GAGE - w/AD.	56J	1
0102-34	1543523		ADAPTER, WATER TEMPERATURE GAGE	57L	1
	G180078		SCREW, TO CYL. HEAD 5/16" - 18X7/8"	16G8, 6H, 56B, 56H, 57B, 57H, 57L	2
	G120393		WASHER, PLAIN 5/16"	16G8, 6H, 56B, 56H, 57B, 57H, 57L	2
	G120214		WASHER, LOCK 5/16"	16G8, 6H, 56B, 56H, 57B, 57H, 57L	2
	G100133		SCREW, TO CYL. HEAD 3/8" - 16X3/4"	56J	1
	471076		STUD, TO CYL. HEAD 3/8" - 24X1 3/4"	56J	1
	G120382		WASHER, LOCK 3/8"	56J	2
	527240		GASKET, WATER TEMPERATURE GAGE ADAPTER	16G8, 6H, 56B, 56H, 57B, 57H, 57L	1
0102-35	440333		GASKET, WATER TEMPERATURE GAGE ADAPTER	56J	1
	531089		TERMINAL, WATER TEMPERATURE GAGE	16G8, 6H, 56B, 56H, 56J	1
	531090		HOUSING, TERMINAL.	16G8, 6H, 56B, 56H, 56J	1

ENGINE

ILLUST. NUMBER	PART NUMBER	CHANGE	DESCRIPTION	MODELS	PER CAR
0102- CYLINDER BLOCK, HEAD AND GASKET-Cont'd. (Plates 01-1, 2, 3, 4, 5, 7, 9)					
CYLINDER HEAD-Cont'd.					
0102-36	532115		OUTLET, ENGINE WATER	16G6, 56G, 57G	1
0102-36	532383		OUTLET, ENGINE WATER	16G8, 6H	1
0102-36	529412		OUTLET, ENGINE WATER - W-F-D-Y-P	56B, 56H, 57B, 57H	1
0102-36	532383		OUTLET, ENGINE WATER - C-K	56B, 56H, 57B,	1
0102-36	1539099		OUTLET, ENGINE WATER	56J	1
0102-36	532383		OUTLET, ENGINE WATER - C-K3	57H	1
0102-36	1542327		OUTLET, ENGINE WATER - K7	57H	1
0102-36	1542327		OUTLET, ENGINE WATER,	57L	1
0102-37	527835		SCREW, THRU CYL. HEAD 7/16" - 14X4 1/8"	16G6, 56G, 57G	2
	G180078		SCREW, TO WATER MANIFOLD 5/16" - 18X7/8"	16G8, 6H, 56B, 56H, 57B, 57H	4
	G179816		SCREW, TO SUPERCHARGER BRKT. 5/16" - 18X3/4"	57H, 57L	4
	G120214		WASHER, LOCK 5/16"	16G8, 6H, 56B, 56H, 57B, 57H, 57L	4
	G179839		SCREW, TO WATER MANIFOLD 3/8" - 16X1"	56J	2
	G120382		WASHER, LOCK 3/8"	56J	2
0102-38	194660		GASKET, ENGINE WATER OUTLET (INCL. IN 536557 SET)	16G6, 56G, 57G	1
0102-38	527284		GASKET, ENGINE WATER OUTLET (INCL. IN 536265 SET)	16G8, 6H, 56B, 56H, 57B, 57H, 57L	1
0102-38	440474		GASKET, ENGINE WATER OUTLET	56J	1
THERMOSTAT - SEE GROUP 0504					
SPARK PLUGS - SEE GROUP 0603					

0103- VALVES AND VALVE MECHANISM (Plates 01-5, 6, 7, 8, 9, 10)



MODELS 16G6, 56G, 57G

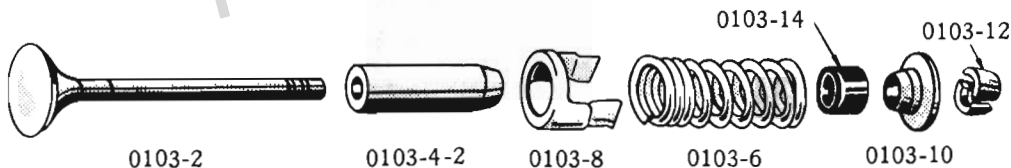

MODELS 16G8, 6H, 56B, 56H, 57B, 57H, 57L

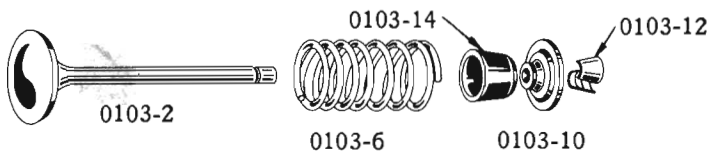

MODEL 56J

C-3127

VALVES, SPRINGS, GUIDES, TAPPETS AND COVERS

0103-1	194216	VALVE, INLET	16G6, 56G, 57G	6
0103-2	194217	VALVE, EXHAUST	16G6, 56G, 57G	6
0103-1	683876	VALVE, INLET	16G8, 6H, 56B, 56H, 57B, 57H, 57L	8
0103-2	535939	VALVE, EXHAUST	16G8, 6H, 56B, 56H, 57B, 57H, 57L	8
0103-1	6480390	VALVE, INLET - STD.	56J	8
0103-1	6480391	VALVE, INLET - .003 OS.	56J	*
0103-1	6480392	VALVE, INLET - .010 OS.	56J	*
0103-1	6480393	VALVE, INLET - .020 OS.	56J	*
0103-1	6480394	VALVE, INLET - .030 OS.	56J	*
0103-2	440664	VALVE, EXHAUST - STD.	56J	8
0103-2	440668	VALVE, EXHAUST - .003 OS.	56J	*
0103-2	440669	VALVE, EXHAUST - .010 OS.	56J	*

NOTE { * - USE AS REQUIRED

ENGINE

0103

ILLUST. NUMBER	PART NUMBER	CHANGE <input checked="" type="checkbox"/>	DESCRIPTION	MODELS	PER CAR
0103- VALVES AND VALVE MECHANISM-Cont'd.					
(Plates 01-5, 6, 7, 8, 9, 10)					
VALVES, SPRINGS, GUIDES, TAPPETS and COVERS-Cont'd.					
0103-2	440670		VALVE, EXHAUST - .020 OS.	56J	*
0103-2	440671		VALVE, EXHAUST - .030 OS.	56J	*
	536426		CAP. VALVE STEM (SERVICE ONLY)	16G8, 6H, 56B, 56H, 57B, 57H, 57L	16
0103-4	194359		GUIDE, VALVE	16G6, 56G, 57G	12
0103-4-1	527088		GUIDE, INLET VALVE	16G8, 6H, 56B, 56H, 57B, 57H, 57L	8
0103-4-2	530222		GUIDE, EXHAUST VALVE	16G8, 6H, 56B, 56H, 57B, 57H, 57L	8
0103-6	514236		SPRING, VALVE	16G6, 56G, 57G	12
0103-6	533245		SPRING, VALVE	16G8, 6H, 56B, 56H, 57B, 57H, 57L	16
0103-6	6480807		SPRING, VALVE	56J	16
0103-8	168535		DAMPER, VALVE SPRING	16G8, 6H, 56B, 56H, 57B, 57H, 57L	16
0103-10	514235		RETAINER, VALVE SPRING	16G6, 56G, 57G	12
0103-10	527766		RETAINER, VALVE SPRING	16G8, 6H, 56B, 56H, 57B, 57H, 57L	16
0103-10	440511		RETAINER, VALVE SPRING	56J	16
0103-12	195286		SEAT, VALVE SPRING	16G6, 56G, 57G	12
0103-12	527180		SEAT, VALVE SPRING (ORDER BY PAIRS)	16G8, 6H, 56B, 56H, 57B, 57H, 57L	32
0103-12	440319		SEAT, VALVE SPRING	56J	32
0103-14	536264		DEFLECTOR, VALVE STEM OIL (INCL. IN 536265 SET)	16G8, 6H, 56B, 56H, 57B, 57H, 57L	16
0103-14	476056		DEFLECTOR, INLET VALVE STEM OIL	56J	8
0103-16	519077		TAPPET OR LIFTER w/SCREW, VALVE - STD.	16G6, 56G, 57G	12
0103-16	519080		TAPPET OR LIFTER w/SCREW, VALVE - .001 OS.	16G6, 56G, 57G	12
0103-16	536649		TAPPET OR LIFTER w/SCREW, VALVE - .005 OS.	16G6, 56G, 57G	12
0103-17	519078		SCREW, ADJUSTING 3/8" - 24X3/4"	16G6, 56G, 57G	12
0103-16	536026		TAPPET OR LIFTER - STD.	16G8, 6H, 56B, 56H, 57B, 57H, 57L	16
0103-16	536224		TAPPET OR LIFTER - .001 OS.	16G8, 6H, 56B, 56H, 57B, 57H, 57L	16
0103-16	536636		TAPPET OR LIFTER - .005 OS.	16G8, 6H, 56B, 56H, 57B, 57H, 57L	16
0103-16	476060		TAPPET OR LIFTER (HYDRAULIC)	56J	16
0103-20	195616		SPRING, VALVE LIFTER	16G6, 56G, 57G	12
0102-22-1	534892		COVER, FRONT, VALVE SPRING	16G6, 56G, 57G	1
0103-22-2	534890		COVER, REAR, VALVE SPRING	16G6, 56G, 57G	1
0103-24-1	G179830		SCREW, TO CYL. BLOCK 5/16" - 18X3"	16G6, 56G, 57G	3
0103-24-2	G186273		SCREW, THRU BREATHER TUBE 5/26" - 18X4 1/4"	16G6, 56G, 57G	1
	G114622		GASKET, SCREW (INCL. IN 536557 SET)	16G6, 56G, 57G	4
0103-25	536554		GASKET, VALVE SPRING COVER (COATED) (INCL. IN 536557 SET)	16G6, 56G, 57G	2
0103-26	527138		COVER, VALVE LIFTER	16G8, 6H, 56B, 56H, 57B, 57H, 57L	1
0103-26	6489200		COVER, VALVE LIFTER	56J	1
	527196		SCREW, TO CYL. BLOCK 5/16" - 18X3 5/8"	16G8, 6H, 56B, 56H, 57B, 57H, 57L	2
0103-26-2	530320		SCREW, THRU BREATHER TUBE 5/16" - 18X5 1/16"	16G8, 6H, 56B, 56H, 57B, 57H, 57L	1
	G442695		SCREW AND WASHER, TO CYL. BLOCK 5/16" - 18X5/8"	56J	6
	G114622		GASKET, SCREW	16G8, 6H, 56B, 56H, 57B, 57H, 57L	3
0103-26-3	527136		GASKET, VALVE LIFTER COVER	16G8, 6H, 56B, 56H, 57B, 57H, 57L	1
0103-26-3	440363		GASKET, VALVE LIFTER COVER (INCL. IN 458670 SET)	56J	1
0103-27	525265		BAFFLE, VALVE CHAMBER OIL	16G6, 56G, 57G	2
	6484396		BAFFLE KIT, VALVE CHAMBER OIL (SERVICE ONLY 1ST 2500 CARS)	56J	1
	⊕ 6489127		BAFFLE, VALVE CHAMBER OIL (AFTER APPROX. 2500 CARS)	56J	4
0103-29	440649		BAFFLE, VALVE LIFTER COVER	56J	1
0103-30	373702		SPRING, VALVE LIFTER COVER BAFFLE	56J	2

⊕ ALSO ORDER 2 PCS. OF 6489048 WASHER WITH EACH BAFFLE

NOTE { * - USED AS REQUIRED.

ENGINE

ILLUST. NUMBER	PART NUMBER	CHANGE ✓	DESCRIPTION	MODELS	PER CAR
0103- VALVES AND VALVE MECHANISM-Cont'd.					
(Plates 01-5, 6, 7, 8, 9, 10)					
ROCKER ARMS, SHAFTS and PUSH RODS					
(Illustr. Plate 14)					
0102-40	536222		ARM W/SCREW, VALVE ROCKER	16G8, 6H, 56B, 56H, 57B, 57H, 57L	16
0103-41	532161		SCREW, ADJUSTING 3/8" -24X7/8"	16G8, 6H, 56B, 56H	16
0103-41	1541806		SCREW, ADJUSTING 3/8" -24X7/8"	57B, 57H, 57L	16
0103-40-1	6440471		ARM, RIGHT, VALVE ROCKER	56J	8
0103-40-2	6440470		ARM, LEFT, VALVE ROCKER	56J	8
0103-45	527199		SPRING, VALVE ROCKER ARM	16G8, 6H, 56B, 56H, 57B, 57H, 57L	6
0103-46	527198		WASHER, SPRING	16G8, 6H, 56B, 56H, 57B, 57H, 57L	4
0103-47	527197		WASHER, INNER, PLAIN 53/64" I.D.	16G8, 6H, 56B, 56H, 57B, 57H, 57L	4
0102-48	531068		WASHER, OUTER, SPECIAL	16G8, 6H, 56B, 56H, 57B, 57H, 57L	4
	----		COTTER, 3/32" X1 1/4"	16G8, 6H, 56B, 56H, 57B, 57H, 57L	4
0103-45	427343		SPRING, VALVE ROCKER ARM	56J	6
0103-46	440089		WASHER, SPRING	56J	4
0103-47	427056		WASHER, SPACER	56J	8
	----		COTTER, 3/32" X1 1/4"	56J	4
0103-50	527890		PUSH ROD, VALVE ROCKER ARM	16G8, 6H, 56B, 56H, 57B, 57H, 57L	16
0103-50	6480610		PUSH ROD, VALVE ROCKER ARM	56J	16
0103-54	527182		SHAFT W/PLUGS, VALVE ROCKER ARM	16G8, 6H, 56B, 56H, 57B, 57H, 57L	2
0103-54	440466		SHAFT W/PLUGS, VALVE ROCKER ARM	56J	2
0103-55	527184		PLUG, CUP 1/2"	16G8, 6H, 56B, 56H, 57B, 57H, 57L	4
0103-55	----		PLUG, CUP 5/8"	56J	4
0103-58	527696		BRACKET, VALVE ROCKER ARM SHAFT	16G8, 6H, 56B, 56H, 57B, 57H, 57L	8
0103-59	527718		SCREW, THRU CYL. HEAD 7/16" -14X6 9/16"	16G8, 6H, 56B, 56H, 57B, 57H, 57L	8
0103-60	527711		STUD, BRACKET AND ROCKER ARM COVER 5/16"		
			24X4 1/4"	16G8, 6H, 56B, 56H, 57B, 57H, 57L	8
	G120214		WASHER, STUD LOCK 5/16"	16G8, 6H, 56B, 56H, 57B, 57H, 57L	8
0103-58	440645		BRACKET, VALVE ROCKER ARM SHAFT	56J	8
0103-59	440140		SCREW, THRU CYL. HEAD 7/16" -14X7 1/4"	56J	8
0103-61	455556		DOWEL, TUBULAR .5670X1/2"	56J	4
0103-63	531475		COVER, VALVE ROCKER ARM (INCL. RETAINERS)	16G8, 6H, 56B, 56H, 57B, 57H, 57L	2
0103-60	527711		STUD, THRU ROCKER ARM SHAFT BRKT. 5/16" -18-		
			24X4 1/4"	16G8, 6H, 56B, 56H, 57B, 57H, 57L	8
0103-64	530851		NUT, CROWN 5/16" -24	16G8, 6H, 56B, 56H, 57B, 57H, 57L	8
0103-65	41X569		WASHER, PLAIN 7/16"	16G8, 6H, 56B, 56H, 57B, 57H, 57L	4
0103-66	530858		GROMMET, COVER-RUBBER	16G8, 6H, 56B, 56H, 57B, 57H, 57L	8
0103-63	471064		COVER, VALVE ROCKER ARM	56J	2
	AC-2796		COVER KIT, VALVE ROCKER ARM CHROME - CONSISTS OF 2		
			COVERS AND GASKETS	56J	1
	G9409101		SCREW AND WASHER, 5/16" -18X5/8"	56J	14
0103-68	536555		GASKET, VALVE ROCKER ARM COVER-COATED (INCL. IN		
			536265 SET)	16G8, 6H, 56B, 56H, 57B, 57H, 57L	2
0103-68	458668		GASKET SET, VALVE ROCKER ARM COVER (2 GASKETS)		
			(INCL. IN 458670 SET)	56J	1
0104- CAMSHAFT AND BEARINGS, GEAR AND COVER					
(Plates 01-5, 6, 7, 8, 9, 10)					
CAMSHAFT and BEARINGS					
0104-1	524882		CAMSHAFT	16G6, 56G, 57G	1
0104-1	534131		CAMSHAFT	16G8, 6H, 56B, 56H, 57B, 57H, 57L	1
0104-1	6480561		CAMSHAFT	56J	1
0104-3	526224		BEARING SET, CAMSHAFT - CONSISTS OF:	16G6, 56G, 57G	1
			1-196971 BEARING, FRONT 1-196973 BEARING, NO. 3		
			1-196972 BEARING, NO. 2 1-196974 BEARING, REAR		
0104-3	529459		BEARING SET, CAMSHAFT - CONSISTS OF:	16G8, 6H, 56B, 56H, 57B, 57H, 57L	1
			1-529460 BEARING, FRONT 1-529462 BEARING NO. 3		
			1-529461 BEARING, NO. 2 1-529463 BEARING NO. 4		
			1-530022 BEARING, REAR		

ENGINE

0104

ILLUST. NUMBER	PART NUMBER	CHANGE <input checked="" type="checkbox"/>	DESCRIPTION	MODELS	PER CAR
0104- CAMSHAFT AND BEARINGS, GEAR AND COVER-Cont'd.					
(Plates 01-5, 6, 7, 8, 9, 10)					
CAMSHAFT and BEARINGS-Cont'd.					
0104-3-1	440380		BEARING, CAMSHAFT, FRONT	56J	1
0104-3-2	440381		BEARING, CAMSHAFT, No. 2	56J	1
0104-3-3	440382		BEARING, CAMSHAFT, No. 3	56J	1
0104-3-4	440383		BEARING, CAMSHAFT, No. 4	56J	1
0104-3-5	440384		BEARING, CAMSHAFT, REAR	56J	1
TIMING GEAR and COVER					
0104-10	534717		GEAR, CAMSHAFT TIMING	16G6, 56G, 57G	1
0104-10	532130		GEAR, CAMSHAFT TIMING	16G8, 6H, 56B, 56H, 57B, 57H, 57L	1
	G124549		KEY, WOODRUFF 3/16" X3/4"	ALL EXCEPT 56J	1
0104-11	G181637		SCREW, TO CAMSHAFT 3/8" -24X1"	16G6, 56G, 57G	1
0104-11	G181639		SCREW, TO CAMSHAFT 3/8" -24X1 1/4"	16G8, 6H, 56B, 56H, 57B, 57H, 57L	1
0104-12	41X570		WASHER, PLAIN 3/8"	16G6, 56G, 57G	1
	G120382		WASHER, LOCK 3/8"	ALL EXCEPT 56J	1
0104-10	440843		SPROCKET, CAMSHAFT TIMING CHAIN	56J	1
	G103907		KEY, WOODRUFF No. 11	56J	1
0104-11	440372		SCREW, TO CAMSHAFT 3/8" -16X1"	56J	1
0104-13	440842		CHAIN, TIMING	56J	1
0104-14	195385		SPACER, CAMSHAFT TIMING GEAR	ALL EXCEPT 56J	1
0104-14	6480917		SPACER, CAMSHAFT TIMING SPROCKET	56J	1
0104-16	194228		THRUST PLATE, TIMING GEAR	16G6, 56G, 57G	1
0104-16	527085		THRUST PLATE, TIMING GEAR	16G8, 6H, 56B, 56H, 57B, 57H, 57L	1
0104-16	6480918		THRUST PLATE, TIMING SPROCKET	56J	1
	512709		SCREW, TO CYL. BLOCK 5/16" -18X3/4"	16G6, 56G, 57G	2
	527857		SCREW, TO CYL. BLOCK 5/16" -18X11/16"	16G8, 6H, 56B, 56H, 57B, 57H, 57L	2
	440366		SCREW, TO CYL. BLOCK 5/16" -18X3/4"	56J	3
	40X125		WASHER, LOCK 5/16"	ALL EXCEPT 56J	2
0104-20	534440		COVER, TIMING GEAR	16G6, 56G, 57G	1
	----		SCREW, TO CYL. BLOCK 5/16" -18X3/4"	16G6, 56G, 57G	4
	G180078		SCREW, TO FILLER BLOCK 5/16" -18X7/8"	16G6, 56G, 57G	4
	G120214		WASHER, LOCK 5/16"	16G6, 56G, 57G	6
	G114622		GASKET, SCREW	16G6, 56G, 57G	2
	G181595		BOLT, TO PLATE 5/16" -24X3/4"	16G6, 56G, 57G	4
	G120368		NUT, HEX. 5/16" -24	16G6, 56G, 57G	4
	G120393		WASHER, PLAIN 5/16"	16G6, 56G, 57G	1
	G120214		WASHER, LOCK 5/16"	16G6, 56G, 57G	4
0104-20	536024		COVER, TIMING GEAR	16G8, 6H, 56B, 56H, 57B, 57H, 57L	1
	G192414		SCREW AND WASHER, TO CYL. BLOCK 5/16" -18X7/8"	16G8, 6H, 56B, 56H, 57B, 57H, 57L	11
	G179826		SCREW, TO CYL. BLOCK 5/16" -18X2"	16G8, 6H, 56B, 56H, 57B, 57H, 57L	2
	G120214		WASHER, LOCK 5/16"	16G8, 6H, 56B, 56H, 57B, 57H, 57L	2
0104-20	440710		COVER, TIMING SPROCKET	56J	1
	G106326		SCREW, TO CYL. BLOCK 5/16" - 18X1 1/8"	56J	8
	G120393		WASHER, PLAIN 11/32"	56J	8
	G120214		WASHER, LOCK 5/16"	56J	8
0104-22	533958		GASKET, TIMING GEAR COVER	16G6, 56G, 57G	1
0104-22	536090		GASKET, TIMING GEAR COVER	16G8, 6H, 56B, 56H, 57B, 57H, 57L	1
0104-22	440061		GASKET, TIMING SPROCKET COVER	56J	1
0104-23	534542		RING, TIMING GEAR COVER OIL COLLECTOR	16G8, 6H, 56B, 56H, 57B, 57H, 57L	1
	2047X1		SCREW, TO COVER No. 10X5/16"	16G8, 6H, 56B, 56H, 57B, 57H, 57L	4
0104-24	197591		WASHER, TIMING GEAR COVER OIL	16G6, 56G, 57G	1
0104-24	167156		WASHER, TIMING GEAR COVER OIL	16G8, 6H, 56B, 56H, 57B, 57H, 57L	1
0104-24	6489724		WASHER, TIMING SPROCKET COVER OIL (INCLS. RETAINER)	56J	1
0104-26	533951		REINFORCEMENT, TIMING GEAR COVER	16G6, 56G, 57G	1

ENGINE

ILLUST. NUMBER	PART NUMBER	CHANGE	DESCRIPTION	MODELS	PER CAR
0105- CRANKSHAFT, BEARINGS, CAPS, GEAR AND DAMPER					
(Plates 01-6, 8, 10)					
CRANKSHAFT					
			USED WITH ENGINE		
0105-1	534382		CRANKSHAFT	16G6.56G.57G	1
0105-1	535134		CRANKSHAFT - NOTE 1 } 224"	16G8	1
0105-1	536454		CRANKSHAFT - NOTE 2 } INCL.PILOT BEARING 259"	16G8.6H.56B.57B	1
0105-1	1539111		CRANKSHAFT 289"	56B.56H.57B.57H.57L	1
0105-1	476009		CRANKSHAFT	56J	1
0105-3	534303		GEAR, CRANKSHAFT TIMING	16G6.56G.57G	1
0105-3	527084		GEAR, CRANKSHAFT TIMING	16G8.6H.56B.56H.57B.57H.57L	1
	G124553		KEY, WOODRUFF 1/4" X1"	ALL MODELS	1
0105-3	440841		SPROCKET, CRANKSHAFT TIMING CHAIN	56J	1
	440686		KEY, FEATHER 3/16" X1/4" X1 15/16"	56J	1
0105-5	533999		THRUST WASHER, CRANKSHAFT	16G6.56G.57G	1
0105-5	527086		THRUST WASHER, CRANKSHAFT	16G8.6H.56B.56H.57B.57H.57L	1
0105-7	537219		SHIM, CRANKSHAFT THRUST WASHER - .003	16G6.56G.57G	*
0105-7	537220		SHIM, CRANKSHAFT THRUST WASHER - .005	16G6.56G.57G	*
0105-7	537221		SHIM, CRANKSHAFT THRUST WASHER - .007	16G6.56G.57G	*
0105-7	186693		SHIM, CRANKSHAFT THRUST WASHER - .003	16G8.6H.56B.56H.57B.57H.57L	*
0105-7	186694		SHIM, CRANKSHAFT THRUST WASHER - .005	16G8.6H.56B.56H.57B.57H.57L	*
0105-7	186695		SHIM, CRANKSHAFT THRUST WASHER - .007	16G8.6H.56B.56H.57B.57H.57L	*
0105-9	197592		SLINGER, CRANKSHAFT OIL	16G6.56G.57G	1
0105-9	189316		SLINGER, CRANKSHAFT OIL	16G8.6H.56B.56H.57B.57H.57L	1
0105-9	440703		SLINGER, CRANKSHAFT OIL	56J	1
	----		BEARING, CLUTCH PILOT - SEE GROUP 0207		
BEARING CAPS and BEARINGS					
0105-15	533939		CAP, FRONT, CRANKSHAFT BEARING (NO. 1)	16G6.56G.57G	1
0105-16.17	533940		CAP, INTERMEDIATE, CRANKSHAFT BEARING (NO. 2 & 3)	16G6.56G.57G	2
0105-22	533941		CAP, REAR, CRANKSHAFT BEARING (NO. 4)	16G6.56G.57G	1
0105-23	537897		SCREW, TO CYL. BLOCK 1/2" -13X2 3/4"	16G6.56G.57G	8
	167772		WASHER, PLAIN 33/64"	16G6.56G.57G	8
0105-15	527066		CAP, FRONT, CRANKSHAFT BEARING (NO. 1)	16G8.6H.56B.56H.57B.57H.57L	1
0105-16.17.18	527067		CAP, INTERMEDIATE, CRANKSHAFT BEARING (NO.2.3 & 4)	16G8.6H.56B.56H.57B.57H.57L	3
0105-22	527233		CAP, REAR, CRANKSHAFT BEARING (NO. 5) (INCL. STUDS)	16G8.6H.56B.56H.57B.57H.57L	1
0105-23	537897		SCREW, TO CYL. BLOCK 1/2" -13X2 3/4"	16G8.6H.56B.56H.57B.57H.57L	10
	167772		WASHER, PLAIN 33/64"	16G8.6H.56B.56H.57B.57H.57L	10
0105-15	476037		CAP, FRONT, CRANKSHAFT BEARING (NO. 1)	56J	1
0105-16.17.18	476038		CAP, INTERMEDIATE, CRANKSHAFT BEARING (NO. 2,3, & 4)	56J	3
0105-22	476039		CAP, REAR, CRANKSHAFT BEARING (NO. 5)	56J	1
0105-23	440065		SCREW, TO CYL. BLOCK 1/2" -13X3 3/8"	56J	10
0105-25	534083		OIL SEAL, REAR BEARING CAP - CORK (INCL. IN 1540605 KIT)	16G6.56G.57G	2
0105-25	530526		OIL SEAL, RIGHT, REAR BEARING CAP -CORK } INCL IN..	16G8.6H.56B.56H.57B.57H.57L	1
	530527		OIL SEAL, LEFT, REAR BEARING CAP - CORK } 1540606 KIT	16G8.6H.56B.56H.57B.57H.57L	1
0105-25	427104		OIL SEAL, REAR BEARING CAP - ASBESTOS	56J	2
0105-27	522144		SEAL, REAR BEARING CAP - RUBBER (INCL. IN 1540605 KIT)	16G6.56G.57G	2
0105-27	527249		SEAL, REAR BEARING CAP - RUBBER (INCL. IN 1540606 KIT)	16G8.6H.56B.56H.57B.57H.57L	2
NOTES	1 - USED WITH 224 CU.IN.ENGINE ON MODEL 16G8 U.S.A. CANADA BEFORE ENGINE NOS. V-331.101 VC-6.201 2 - USED WITH 259 CU.IN.ENGINE ON MODEL 16G8 SO.BEND LOS ANGELES CANADA ON AND AFTER ENGINE NOS. V-331.101 VL-101 VC-6.201 * - USE AS REQUIRED.				

ENGINE

0105

ILLUST. NUMBER	PART NUMBER	CHANGE <input checked="" type="checkbox"/>	DESCRIPTION	MODELS	PER CAR
0105- CRANKSHAFT, BEARINGS, CAPS, GEAR AND DAMPER-					
Cont'd. (Plates 01-6, 8, 10)					
BEARING CAPS and BEARINGS-Cont'd.					
0105-30 31, 32, 37	534993		BEARING SET, CRANKSHAFT - STANDARD - CONSISTS OF: . 1-535405 BEARING, FRONT 1-534988 BEARING, REAR 2-535406 BEARING, NO. 2,3	16G6.56G.57G	1
0105-30 31, 32, 37	534994		BEARING SET, CRANKSHAFT - .001 UNDERSIZE - CON- SISTS OF: 1-534979 BEARING, FRONT 1-534989 BEARING, REAR 2-534984 BEARING, NO. 2,3	16G6.56G.57G	1
0105-30 31, 32, 37	534995		BEARING SET, CRANKSHAFT - .010 UNDERSIZE - CON- SISTS OF: 1-534980 BEARING, FRONT 1-534990 BEARING, REAR 2-534985 BEARING, NO. 2,3	16G6.56G.57G	1
0105-30 31, 32, 37	534996		BEARING SET, CRANKSHAFT - .020 UNDERSIZE - CON- SISTS OF: 1-534981 BEARING, FRONT 1-534991 BEARING, REAR 2-534986 BEARING, NO. 2,3	16G6.56G.57G	1
0105-30 31, 32, 37	534997		BEARING SET, CRANKSHAFT - .030 UNDERSIZE - CON- SISTS OF: 1-534982 BEARING, FRONT 1-534992 BEARING, REAR 2-534987 BEARING, NO. 2,3	16G6.56G.57G	1
0105-30 31, 32, 33, 37	530796		BEARING SET, CRANKSHAFT - STANDARD - CONSISTS OF: . 1-530781 BEARING, FRONT 1-530791 BEARING, REAR 3-530786 BEARING, NO. 2, 3,4	16G8.6H.56B.56H.57B.57H.57L.	1
0105-30 31, 32, 33, 37	530797		BEARING SET, CRANKSHAFT - .001 UNDERSIZE - CON- SISTS OF: 1-530782 BEARING, FRONT 1-530792 BEARING, REAR 3-530787 BEARING, NO. 2, 3,4	16G8.6H.56B.56H.57B.57H.57L.	1
0105-30 31, 32, 33, 37	530798		BEARING SET, CRANKSHAFT - .010 UNDERSIZE - CON- SISTS OF: 1-530783 BEARING, FRONT 1-530793 BEARING, REAR 3-530788 BEARING, NO. 2, 3,4	16G8.6H.56B.56H.57B.57H.57L.	1
0105-30 31, 32, 33, 37	530799		BEARING SET, CRANKSHAFT - .020 UNDERSIZE - CON- SISTS OF: 1-530784 BEARING, FRONT 1-530794 BEARING, REAR 3-530789 BEARING, NO. 2, 3,4	16G8.6H.56B.56H.57B.57H.57L.	1
0105-30 31, 32, 33, 37	530800		BEARING SET, CRANKSHAFT - .030 UNDERSIZE - CON- SISTS OF: 1-530785 BEARING, FRONT 1-530795 BEARING, REAR 3-530790 BEARING, NO. 2, 3,4	16G8.6H.56B.56H.57B.57H.57L.	1
0105-30.31 32, 33, 37	458400		BEARING SET, CRANKSHAFT - STD. - CONSISTS OF: . . . 4-458412 BEARING NO. 1, 1-458416 BEARING, REAR 2,3,4	56J	1
0105-30.31 32, 33, 37	458401		BEARING SET, CRANKSHAFT - .001 US. - CONSISTS OF: . . . 4-458413 BEARING NO. 1, 1-458417 BEARING, REAR 2,3,4	56J	1

CRANKSHAFT BEARINGS SHOULD ALWAYS BE ORDERED IN SETS. THE SEPARATE BEARINGS WHICH COMPRISE THESE SETS MAY STILL BE OBTAINED AT THE FACTORY BUT SHOULD BE ORDERED ONLY WHEN A BEARING IN A SET HAS BEEN DAMAGED DURING INSTALLATION. SEE ABOVE LISTINGS OF BEARING SETS AND COMPONENT PARTS.

ENGINE

ILLUST. NUMBER	PART NUMBER	CHANGE	DESCRIPTION	MODELS	PER CAR
0105- CRANKSHAFT, BEARINGS, CAPS, GEAR AND DAMPER- Cont'd. (Plates 01-6, 8, 10) BEARING CAPS and BEARINGS-Cont'd.					
0105-30,31, 32,33,37	458402	✓	BEARING SET, CRANKSHAFT - .002 US. - CONSISTS OF: 4-458414 BEARING, NO. 1 1-458418 BEARING, REAR 2,3,4	56J	1
0105-30,31, 32,33,37	458403		BEARING SET, CRANKSHAFT - .020 US. - CONSISTS OF: 4-458415 BEARING, NO. 1 1-458419 BEARING, REAR 2,3,4	56J	1
	1540605		OIL SEAL KIT, CRANKSHAFT REAR BEARING - CONSISTS OF:	16G6, 56G, 57G	1
			2-534527 REAR BEARING SEAL		
			2-522144 REAR BEARING CAP SEAL		
	1540606		OIL SEAL KIT, CRANKSHAFT REAR BEARING - CONSISTS OF:	16G8, 6H, 56B, 56H, 57B, 57H, 57L	1
			2-530311 REAR BEARING SEAL		
			2-527249 REAR BEARING CAP SEAL		
0105-40	534527		OIL SEAL, CRANKSHAFT REAR BEARING - RUBBER (INCL. IN 1540605 KIT)	16G6, 56G, 57G	2
0105-40	530311		OIL SEAL, CRANKSHAFT REAR BEARING - RUBBER (INCL. IN 1540606 KIT)	16G8, 6H, 56B, 56H, 57B, 57H, 57L	2
VIBRATION DAMPER					
0105-45	519387		FLYWHEEL, VIBRATION DAMPER	16G6, 56G, 57G	1
0105-45	536563		FLYWHEEL, VIBRATION DAMPER - NOTE 1	16G8	1
0105-45	533128		FLYWHEEL, VIBRATION DAMPER - NOTE 2	16G8, 6H, 56B, 56H, 57B, 57H, 57L	1
0105-45	440715		FLYWHEEL, VIBRATION DAMPER (INCL. FAN PULLEY)	56J	1
0105-46	515111		SCREW, TO CRANKSHAFT 11/16" - 16X2 1/16"	16G6, 56G, 57G	1
0105-46	515111		SCREW, TO CRANKSHAFT 11/16" - 16X2 1/16" (LESS POWER STEER).	16G8, 6H, 56B, 56H, 57B, 57H, 57L	1
0105-46	534295		SCREW, TO CRANKSHAFT 11/16" - 16X2 5/8" (WITH POWER STEER).	16G8, 6H, 56B, 56H, 57B, 57H, 57L	1
0105-46	537522		SCREW, TO CRANKSHAFT 11/16" - 16X3" (W/AIR CONDITIONER).	16G8, 6H, 56B, 56H, 57B, 57H, 57L	1
0105-46	537522		SCREW, TO CRANKSHAFT 11/16" - 16X3" (W/SUPERCHARGER).	57H, 57L	1
0105-46	440598		SCREW, TO CRANKSHAFT 3/4" - 16X1 3/8"	56J	1
0105-47	515202		LOCK PLATE	ALL EXCEPT 56J	1
0105-48	522490		WASHER, PLAIN 11/16"	ALL EXCEPT 56J	1
0105-48	6300063		WASHER, PLAIN 3/4"	56J	1
0105-49	186703		CUSHION, FRONT, VIBRATION DAMPER - RUBBER	ALL EXCEPT 56J	1
0105-50	186704		CUSHION, REAR, VIBRATION DAMPER - RUBBER	ALL EXCEPT 56J	1
0105-52	186702		PLATE, VIBRATION DAMPER LOCK, (LESS POWER STEER).	16G6, 56G, 57G	1
0105-52	533278		PLATE, VIBRATION DAMPER LOCK, (WITH POWER STEER).	16G6, 56G, 57G	1
0105-52	186702		PLATE, VIBRATION DAMPER LOCK, (NOT USED AIR COND)	16G8, 6H, 56B, 56H, 57B, 57H, 57L	1
0105-54	510113		PILOT, VIBRATION DAMPER 1 3/16" LONG } LESS POWER	16G6, 56G, 57G	4
0105-54	182083		PILOT, VIBRATION DAMPER 1 13/32" LONG } STEER	16G6, 56G, 57G	2
0105-57	534530		PULLEY, FAN DRIVE (LESS POWER STEER)	16G6, 56G, 57G	1
0105-57	534470		PULLEY, FAN DRIVE (WITH POWER STEER)	16G6, 56G, 57G	1
0105-57	533890		PULLEY, FAN DRIVE	16G8, 6H, 56B, 56H, 57B, 57H, 57L	1
	-----		PULLEY, FAN DRIVE (PART OF DAMPER FLYWHEEL)	56J	1
	G124549		KEY, WOODRUFF 3/16" X 3/4"	16G6, 56G, 57G	1

NOTES { 1 - Used with 224 CU. IN. ENGINE ON MODEL 16G8 U.S.A. | CANADA
BEFORE ENGINE NOS. V-331,101 | VC-6,201
2 - Used with 259 CU. IN. ENGINE ON MODEL 16G8 So. BEND | LOS ANGELES | CANADA
ON AND AFTER ENGINE NOS. V-331,101 | VL-101 | VC-6,201

ENGINE

0106

ILLUST. NUMBER	PART NUMBER	CHANGE	DESCRIPTION	MODELS	PER CAR
0105- CRANKSHAFT, BEARINGS, CAPS, GEAR AND DAMPER					
Cont'd. (Plates 01-6,8,10)					
VIBRATION DAMPER - Cont'd.					
	178762		BOLT, TO DAMPER 5/16" -24X1 3/8" (WITH POWER STEER)	16G6, 56G, 57G	6
	G120368		NUT, HEX. 5/16"-24	16G6, 56G, 57G	6
	G120214		WASHER, LOCK 5/16"	16G6, 56G, 57G	6
0105-60	527252		HUB, FAN DRIVE PULLEY	16G8, 6H, 56B, 56H, 57B, 57H, 57L	1
	G124549		KEY, WOODRUFF 3/16" X 3/4"	16G8, 6H, 56B, 56H, 57B, 57H, 57L	1
	178762		BOLT, TO PULLEY 5/16" -24X1 3/8" (LESS POWER STEER)	16G8, 6H, 56B, 56H, 57B, 57H	6
	534350		BOLT, TO PULLEY 5/16" -24X2 1/8" (WITH POWER STEER)	16G8, 6H, 56B, 56H, 57B, 57H	6
	537519		BOLT, TO PULLEY 5/16" -24X2 11/16" (W/AIR CONDITIONER)	16G8, 6H, 56B, 56H, 57B, 57H	6
	537519		BOLT, TO PULLEY 5/16" -24X2 11/16" (WITH SUPERCHARGER)	57H, 57L	6
	G120368		NUT, HEX. 5/16" -24	16G8, 6H, 56B, 56H, 57B, 57H, 57L	6
	G120214		WASHER, LOCK 5/16"	16G8, 6H, 56B, 56H, 57B, 57H, 57L	6
AUTOMATIC DRIVE PLATE (With AD.) (Illust. Page 16)					
0105-65	527800		PLATE, CRANKSHAFT TO CONVERTER DRIVE - w/AD. (USED WITH STUDEBAKER AUTOMATIC TRANS.)	16G, 6H, 56G	1
0105-65	1539081		PLATE, CRANKSHAFT TO CONVERTER DRIVE - w/AD. -FLIGHT-O-MATIC.	56G, 56B, 56H, 57G, 57B, 57H, 57L	1
0105-66	534587		SCREW, TO CRANKSHAFT 3/8" -24X27/32"	16G6, 56G, 57G	6
	G120382		WASHER, LOCK 3/8"	16G6, 56G, 57G	6
0105-66	526851		BOLT, TO CRANKSHAFT 3/8" -24X15/16"	16G8, 6H, 56B, 56H, 57B, 57H, 57L	6
	G451010		NUT, LOCK 3/8" -24	16G8, 6H, 56B, 56H, 57B, 57H, 57L	6
0105-68	527801		REINFORCEMENT, C/S TO CONVERTER DRIVE PLATE - w/AD.	ALL EXCEPT 56J	1
POWER STEERING DRIVE PULLEY					
0105-70	533891		PULLEY, POWER STEERING DRIVE	16G6, 56G, 57G	1
0105-70	533890		PULLEY, POWER STEERING DRIVE	16G8, 6H, 56B, 56H, 57B, 57H	1
0105-70	455815		PULLEY, POWER STEERING DRIVE	56J	1
0105-73	534294		SPACER, POWER STEERING DRIVE PULLEY (EXCEPT 57H-K7)	16G8, 6H, 56B, 56H, 57B, 57H	1
SUPERCHARGER DRIVE PULLEY					
0105-78	535843		PULLEY, SUPERCHARGER DRIVE (ILLUST. PLATE 03-13).	57H, 57L	1
	534293		SPACER, SUPERCHARGER DRIVE PULLEY	57H, 57L	1
0106- FLYWHEEL AND STARTER GEAR (Plates 01-6,8,10)					
0106-1	534003		FLYWHEEL w/STARTER GEAR - w/ST. & OD. (INCLS. PILOT BRG.)	16G6	1
0106-1	536327		FLYWHEEL w/STARTER GEAR - w/ST. & OD. - NOTE 1..224"	16G8	1
0106-1	536267		FLYWHEEL w/STARTER GEAR - w/ST. & OD. - NOTE 2..259"	16G8, 6H	1
0106-1	1539748		FLYWHEEL w/STARTER GEAR - w/ST. & OD. (INCLS. PILOT BRG.)	56G, 57G	1
0106-1	1539746		FLYWHEEL w/STARTER GEAR - w/ST. & OD.	56B, 56H, 57B, 57H, 57L	1
0106-1	440529		FLYWHEEL w/STARTER GEAR - w/OD.	56J	1
0106-1	440531		FLYWHEEL w/STARTER GEAR - w/AD.	56J	1
0106-2	534532		SCREW, TO CRANKSHAFT 3/8" -24X1 1/8"	16G6, 56G, 57G	6
	G120382		WASHER, LOCK 3/8"	16G6, 56G, 57G	6
0106-2	194542		BOLT, TO CRANKSHAFT 3/8" -24X1 13/16"	16G8, 6H, 56B, 56H, 57B, 57H, 57L	6
	G120369		NUT, HEX. 3/8" -24X1 13/16"	16G8, 6H, 56B, 56H, 57B, 57H, 57L	6
	G120382		WASHER, LOCK 3/8"	16G8, 6H, 56B, 56H, 57B, 57H, 57L	6
0106-2	443171		SCREW, TO CRANKSHAFT 7/16" -20X9/16"	56J	6

NOTES	1 - USED WITH 224 CU.IN. ENGINE ON MODEL 16G8 BEFORE ENGINE NOS.	U.S.A. V-331.101	CANADA VC-6.201
	2 - USED WITH 259 CU.IN. ENGINE ON MODEL 16G8 ON AND AFTER ENGINE NOS.	So. BEND V-331.101	CANADA LOS ANGELES VL-101 CANADA VC-6.201

ILLUST. NUMBER	PART NUMBER	CHANGE ✓	DESCRIPTION	MODELS	PER CAR
0106- FLYWHEEL AND STARTER GEAR (Plates 01-6,8,10)					
Cont'd.					
0106-6	525271		GEAR, STARTER RING - W/ST. & OD.	16G6	1
0106-6	525272		GEAR, STARTER RING - W/ST. & OD.	16G8,6H	1
0106-6	1539747		GEAR, STARTER RING - W/ST. & OD.	56G,57G	1
0106-6	1539745		GEAR, STARTER RING - W/ST. & OD.	56B,56H,57B,57H,57L	1
0106-6	440532		GEAR, STARTER RING - W/OD.	56J	1
	----		HOUSING, UPPER, FLYWHEEL (INTEGRAL WITH CYL. BLOCK).	56J	1
0106-10	6480519		HOUSING, LOWER, FLYWHEEL	56J	1
	G427934		SCREW, TO CYL. BLOCK 3/8" -16X1 1/4"	56J	2
	G427940		SCREW, TO CYL. BLOCK 3/8" -16X1 1/2"	56J	4
	G120382		WASHER, LOCK 3/8"	56J	6
	G141246		DOWEL, PIN 3/8" X1 1/4"	56J	2
0106-12	440975		COVER, LOWER HOUSING INSPECTION HOLE	56J	1
	----		SCREW, TO HOUSING 1/4" -20X1/2"	56J	2
	----		HOUSING, CLUTCH AND FLYWHEEL - SEE GROUP 0209		
0107- CONNECTING RODS AND BEARINGS (Plates 01-6,8,10)					
0107-1	517921		CONNECTING ROD, LESS BEARING (No. 1,3,5)	16G6,56G,57G	3
0107-1	517922		CONNECTING ROD, LESS BEARING (No. 2,4,6)	16G6,56G,57G	3
0107-3	533801		BOLT, ROD CAP 11/32" -24X2 1/4"	16G6,56G,57G	12
0107-4	196685		NUT, HEX. 11/32" -24	16G6,56G,57G	12
0107-5	196710		NUT, PAL 11/32"	16G6,56G,57G	12
0107-7	197299		SCREW, TAPERED, PISTON PIN LOCK 3/8" -24X 1 11/16"	16G6,56G,57G	6
	G120369		NUT, HEX. 3/8" -24	16G6,56G,57G	6
	G138489		WASHER, SHAKEPROOF 3/8"	16G6,56G,57G	6
0107-1	527114		CONNECTING ROD, LESS BEARING (No. 1,3,5,7)	16G8,6H,56B,56H,57B,57H,57L	4
0107-1	527115		CONNECTING ROD, LESS BEARING (No. 2,4,6,8)	16G8,6H,56B,56H,57B,57H,57L	4
0107-3	527089		BOLT, ROD CAP 3/8" -24X2 13/32"	16G8,6H,56B,56H,57B,57H,57L	16
0107-4	197402		NUT, HEX. 3/8" -24	16G8,6H,56B,56H,57B,57H,57L	16
0107-5	G107828		NUT, PAL 3/8"	16G8,6H,56B,56H,57B,57H,57L	16
0107-7	529348		SCREW, TAPERED, PISTON PIN LOCK 3/8" -24X1 27/32"	16G8,6H,56B,56H,57B,57H,57L	8
	G120369		NUT, HEX. 3/8" -24	16G8,6H,56B,56H,57B,57H,57L	8
	G138489		WASHER, SHAKEPROOF 3/8"	16G8,6H,56B,56H,57B,57H,57L	8
0107-1	440775		CONNECTING ROD W/BUSHING, LESS BEARING	56J	8
0107-3	440776		BOLT, ROD CAP 3/8" -24X2 1/4"	56J	16
0107-4	427042		NUT, SELF LOCKING 3/8" -24	56J	16
0107-10	520834		BEARING UNIT, CONNECTING ROD - STD.	16G6,56G,57G	6
0107-10	522292		BEARING UNIT, CONNECTING ROD - .001 US.	16G6,56G,57G	6
0107-10	536188		BEARING UNIT, CONNECTING ROD - .002 US.	16G6,56G,57G	6
0107-10	520836		BEARING UNIT, CONNECTING ROD - .010 US.	16G6,56G,57G	6
0107-10	520837		BEARING UNIT, CONNECTING ROD - .020 US.	16G6,56G,57G	6
0107-10	685060		BEARING UNIT, CONNECTING ROD - STD.	16G8,6H,56B,56H,57B,57H,57L	8
0107-10	685061		BEARING UNIT, CONNECTING ROD - .001 US.	16G8,6H,56B,56H,57B,57H,57L	8
0107-10	685062		BEARING UNIT, CONNECTING ROD - .002 US.	16G8,6H,56B,56H,57B,57H,57L	8
0107-10	685064		BEARING UNIT, CONNECTING ROD - .010 US.	16G8,6H,56B,56H,57B,57H,57L	8
0107-10	685065		BEARING UNIT, CONNECTING ROD - .020 US.	16G8,6H,56B,56H,57B,57H,57L	8
0107-10	458406		BEARING UNIT, CONNECTING ROD - STD.	56J	8
0107-10	458407		BEARING UNIT, CONNECTING ROD - .001 US.	56J	8
0107-10	458408		BEARING UNIT, CONNECTING ROD - .002 US.	56J	8
0107-10	458409		BEARING UNIT, CONNECTING ROD - .020 US.	56J	8

ENGINE

0108

ILLUST. NUMBER	PART NUMBER	CHANGE <input checked="" type="checkbox"/>	DESCRIPTION	MODELS	PER CAR
0108- PISTONS, PINS AND RINGS (Plates 01-6, 8, 10)					
PISTONS AND PINS					
0108-1	524383		PISTON w/PIN - STD.	16G6.56G.57G.	6
0108-1	534946		PISTON w/PIN - .010 OS.	16G6.56G.57G.	6
0108-1	534948		PISTON w/PIN - .020 OS.	16G6.56G.57G.	6
0108-1	534949		PISTON w/PIN - .030 OS.	16G6.56G.57G.	6
0108-1	534999		PISTON w/PIN - .040 OS.	16G6.56G.57G.	6
0108-1	536198		PISTON w/PIN. STD.	16G8.	8
0108-1	536226		PISTON w/PIN. .010 OS }	16G8.	8
0108-1	536227		PISTON w/PIN. .020 OS } NOTE 1	16G8.	8
0108-1	536228		PISTON w/PIN. .030 OS }	16G8.	8
0108-1	536229		PISTON w/PIN. .040 OS }	16G8.	8
0108-1	536199		PISTON w/PIN. STD.	16G8.6H	8
0108-1	536234		PISTON w/PIN. .010 OS }	16G8.6H	8
0108-1	536235		PISTON w/PIN. .020 OS } NOTE 2	16G8.6H	8
0108-1	536236		PISTON w/PIN. .030 OS }	16G8.6H	8
0108-1	536237		PISTON w/PIN. .040 OS }	16G8.6H	8
USED WITH ENGINE					
0108-1	1539556		PISTON w/PIN - STD. 259"	56B.57B	8
0108-1	1539565		PISTON w/PIN - .010 OS. 259"	56B.57B	8
0108-1	1539566		PISTON w/PIN - .020 OS. 259"	56B.57B	8
0108-1	1539567		PISTON w/PIN - .030 OS. 259"	56B.57B	8
0108-1	1539568		PISTON w/PIN - .040 OS. 259"	56B.57B	8
0108-1	1539044		PISTON w/PIN - STD. 289"	56B.56H.57B.57H.57L	8
0108-1	1539049		PISTON w/PIN - .010 OS. 289"	56B.56H.57B.57H.57L	8
0108-1	1539050		PISTON w/PIN - .020 OS. 289"	56B.56H.57B.57H.57L	8
0108-1	1539051		PISTON w/PIN - .030 OS. 289"	56B.56H.57B.57H.57L	8
0108-1	1539052		PISTON w/PIN - .040 OS. 289"	56B.56H.57B.57H.57L	8
0108-1	6484020		PISTON w/PIN - STD.	56J	8
0108-1	6484021		PISTON w/PIN - .010 OS.	56J	8
0108-1	6484022		PISTON w/PIN - .020 OS.	56J	8
0108-1	6484023		PISTON w/PIN - .030 OS.	56J	8
0108-1	6484677		PISTON w/PIN - STD.	56J	8
0108-1	6484678		PISTON w/PIN - .010 OS. } USED WITH LOW	56J	8
0108-1	6484679		PISTON w/PIN - .020 OS. } COMPRESSION CYLINDER.	56J	8
0108-1	6484680		PISTON w/PIN - .030 OS. } HEAD - EXPORT AND	56J	8
				CANADA	8
0108-3	195268		PISTON PIN - STD.	16G6.56G.57G.	6
0108-3	195873		PISTON PIN - .0025 OS.	16G6.56G.57G.	6
0108-3	195874		PISTON PIN - .005 OS.	16G6.56G.57G.	6
0108-3	536243		PISTON PIN - STD.	16G8.6H.56B.56H.57B.57H.57L	8
0108-3	536244		PISTON PIN - .0025 OS.	16G8.6H.56B.56H.57B.57H.57L	8
0108-3	536245		PISTON PIN - .005 OS.	16G8.6H.56B.56H.57B.57H.57L	8
0108-3	440405		PISTON PIN - STD.	56J	8
0108-3	458513		PISTON PIN - .003 OS.	56J	8
0108-3	458514		PISTON PIN - .006 OS.	56J	8
0108-3-1	440995		LOCK RING	56J	16
0108-4	440043		BUSHING, PISTON PIN (INCL. IN CONN. ROD).	56J	8

NOTES { 1 - USED WITH 224 CU.IN.ENGINE ON MODEL 16G8 U.S.A. | CANADA
 BEFORE ENGINE NOS. V-331.101 | VC-6.201

2 - USED WITH 259 CU.IN.ENGINE ON MODEL 16G8 So.BEND | LOS ANGELES | CANADA
 ON AND AFTER ENGINE NOS. V-331.101 | VL-101 | VC-6.201

ENGINE

ILLUST. NUMBER	PART NUMBER	CHANGE	DESCRIPTION	MODELS	PER CAR
0108- PISTONS, PINS AND RINGS-Cont'd.					
(Plates 01-6, 8, 10)					
PISTON RINGS					
0108-7. 8.9	518102	●	PISTON RING SET, STD. - CONSISTS OF: 6-196596 COMP. RING, TOP 6-520203 OIL RING AND 6-196575 COMP. RING, 2ND INNER RING	16G6.56G.57G.	1
0108-7. 8.9	518103	●	PISTON RING SET, .020 OS. - CONSISTS OF: 6-196614 COMP. RING, TOP 6-520204 OIL RING AND 6-196617 COMP. RING, 2ND INNER RING	16G6.56G.57G.	1
0108-7. 8.9	518104	●	PISTON RING SET, .030 OS. - CONSISTS OF: 6-196615 COMP. RING, TOP 6-520205 OIL RING AND 6-196618 COMP. RING, 2ND. INNER RING	16G6.56G.57G.	1
0108-7. 8.9	522695	●	PISTON RING SET, .040 OS. - CONSISTS OF: 6-522115 COMP. RING, TOP 6-522448 OIL RING AND 6-522116 COMP. RING, 2ND. INNER RING	16G6.56G.57G.	1
0108-7. 8.9	527033	■	PISTON RING SET, STD. - CONSISTS OF: 6-527028 COMP. RING, TOP 6-520203 OIL RING AND 6-196575 COMP. RING, 2ND. INNER RING	16G6.56G.57G.	1
0108-7 8.9	527035	■	PISTON RING SET, .020 OS. - CONSISTS OF: 6-527030 COMP. RING, TOP 6-520204 OIL RING AND 6-196617 COMP. RING, 2ND. INNER RING	16G6.56G.57G.	1
0108-7. 8.9	527036	■	PISTON RING SET, .030 OS. - CONSISTS OF: 6-527031 COMP. RING, TOP 6-520205 OIL RING AND 6-196618 COMP. RING, 2ND. INNER RING	16G6.56G.57G.	1
0108-7. 8.9	527037	■	PISTON RING SET, .040 OS. - CONSISTS OF: 6-527032 COMP. RING, TOP 6-522448 OIL RING AND 6-522116 COMP. RING, 2ND. INNER RING	16G6.56G.57G.	1
	1539636	#	PISTON RING SET, STANDARD - CONSISTS OF: 6-527028 COMP. RING, TOP 6-520203 OIL RING AND 6-196575 COMP. RING, 2ND. INNER RING	16G6.56G.57G.	1
	1539637	#	PISTON RING SET, .020 OS. - CONSISTS OF: 6-527030 COMP. RING, TOP 6-520204 OIL RING AND 6-196617 COMP. RING, 2ND. INNER RING	16G6.56G.57G.	1
	1539638	#	PISTON RING SET, .030 OS. - CONSISTS OF: 6-527031 COMP. RING, TOP 6-520205 OIL RING AND 6-196618 COMP. RING, 2ND. INNER RING	16G6.56G.57G.	1
0108-7. 8.9	536252	●	PISTON RING SET, STANDARD - CONSISTS OF: 16-537227 COMP. RING 8-536803 OIL RING AND INNER RING	16G8.6H.56B.56H.57B.57H.57L	1
0108-7. 8.9	536253	●	PISTON RING SET, .020 OS. - CONSISTS OF: 16-537228 COMP. RING 8-536804 OIL RING AND INNER RING	16G8.6H.56B.56H.57B.57H.57L	1
0108-7. 8.9	536254	●	PISTON RING SET, .030 OS. - CONSISTS OF: 16-537229 COMP. RING 8-536805 OIL RING AND INNER RING	16G8.6H.56B.56H.57B.57H.57L	1

NOTES { ● - TYPE WITH STANDARD TOP RING
 ■ - TYPE WITH CHROME PLATED TOP RING
 # - TYPE 98 WITH CHROME PLATED TOP RING

ENGINE

0108

ILLUST. NUMBER	PART NUMBER	CHANGE	DESCRIPTION	MODELS	PER CAR	
0108- PISTONS, PINS AND RINGS-Cont'd.						
(Plates 01-6, 8, 10)						
PISTON RINGS-Cont'd.						
0108-7. 8,9	536255	●	PISTON RING SET, .040 OS. - 16-537230 COMP. RING	CONSISTS OF: 1-536806 OIL RING AND INNER RING	16G8.6H, 56B, 56H, 57B, 57H, 57L	1
0108-7. 8,9	536812	■	PISTON RING SET, STANOARD 8-536808 COMP. RING, TOP	CONSISTS OF: 8-536803 OIL RING AND INNER RING	16G8.6H, 56B, 56H, 57B, 57H, 57L	1
			8-537227 COMP. RING, 2ND.			
0108-7. 8,9	536813	■	PISTON RING SET, .020 OS. - 8-536809 COMP. RING, TOP	CONSISTS OF: 8-536804 OIL RING AND INNER RING	16G8.6H, 56B, 56H, 57B, 57H, 57L	1
			8-537228 COMP. RING, 2ND.			
0108-7. 8,9	536814	■	PISTON RING SET, .030 OS. - 8-536810 COMP. RING, TOP	CONSISTS OF: 8-536805 OIL RING AND INNER RING	16G8.6H, 56B, 56H, 57B, 57H, 57L	1
			8-537229 COMP. RING, 2ND.			
0108-7 8,9	536815	■	PISTON RING SET, .040 OS. - 8-536811 COMP. RING, TOP	CONSISTS OF: 8-536806 OIL RING AND INNER RING	16G8.6H, 56B, 56H, 57B, 57H, 57L	1
			8-537230 COMP. RING, 2ND.			
	1539645	#	PISTON RING SET, STANDARO - 8-536808 COMP. RING, TOP	CONSISTS OF: 8----- OIL RING ASSY.	16G8.6H, 56B, 56H, 57B, 57H, 57L	1
			8-537227 COMP. RING, 2ND.			
	1539646	#	PISTON RING SET, .020 OS. - 8-536809 COMP. RING, TOP	CONSISTS OF: 8----- OIL RING ASSY.	16G8.6H, 56B, 56H, 57B, 57H, 57L	1
			8-537228 COMP. RING, 2ND.			
	1539647	#	PISTON RING SET, .030 OS. - 8-536810 COMP. RING, TOP	CONSISTS OF: 8----- OIL RING ASSY.	16G8.6H, 56B, 56H, 57B, 57H, 57L	1
			8-537229 COMP. RING, 2ND.			
0108-10	474170		PISTON RING SET, STANOARD - 8-440028 COMP. RING, TOP	CONSISTS OF: 8----- OIL RING ASSY.	56J	1
			8-440024 COMP. RING, 2ND.			
0108-10	474171		PISTON RING SET, .020 OS. - 8-440029 COMP. RING, TOP	CONSISTS OF: 8----- OIL RING ASSY.	56J	1
			8-440025 COMP. RING, 2ND.			
0108-10	474172		PISTON RING SET, .030 OS. - 8-458381 COMP. RING, TOP	CONSISTS OF: 8----- OIL RING ASSY.	56J	1
			8-458383 COMP. RING, 2ND.			

PISTON RINGS SHOULD ALWAYS BE ORDERED IN SETS. THE SEPARATE RINGS WHICH COMPRISE THESE SETS MAY STILL BE OBTAINED AT THE FACTORY BUT SHOULD BE ORDERED ONLY WHEN A RING IN A SET HAS BEEN DAMAGED OR BROKEN DURING INSTALLATION. SEE ABOVE LISTING OF RING SETS AND COMPONENT PARTS.

- NOTES** {
- - TYPE WITH STANDARD TOP RING
 - - TYPE WITH CHROME PLATED TOP RING
 - # - TYPE 98 WITH CHROME PLATED TOP RING

ENGINE

ILLUST. NUMBER	PART NUMBER	CHANGE	DESCRIPTION	MODELS	PER CAR
<p>0109- INLET AND EXHAUST MANIFOLDS AND HEAT CONTROL (Plates 01-5,7,9,11,12)</p> <p style="text-align: center;">MANIFOLDS</p>					
0109-1	532734		MANIFOLD w/BUSHING, INLET AND EXHAUST	16G6,56G,57G	1
	G103883		PLUG, PIPE 1/8"	16G6,56G,57G	1
0109-9	520458		PLUG, HEATER VALVE SHAFT HOLE	16G6,56G,57G	1
	G103877		PLUG, PIPE 1/8" (USED WITH ELECTRIC WIPER)	16G6,56G,57G	1
	526447		STUD, END TO CYL. BLOCK 3/8" -16-24X1 11/16"	16G6,56G,57G	2
	37X212		STUD, CENTER, TO CYL. BLOCK 3/8" -16-24X2 1/16"	16G6,56G,57G	4
	37X211		STUD, EXHAUST PIPE FLANGE 3/8" -16-24X1 3/8"	16G6,56G,57G	2
	G114547		NUT, HEX 3/8" -24	16G6,56G,57G	8
	41X243		WASHER, PLAIN 13/32"	16G6,56G,57G	2
0109-11	535617P		CLAMP, TO CYL BLOCK	16G6,56G,57G	4
0109-2	534854		MANIFOLD w/PLUGS, INLET (2 BARREL CARB)	16G8,56B,56H,57B,57H	1
0109-2	1542825		MANIFOLD w/PLUGS, INLET (2 BARREL CARB) (WITH SUPERCHARGER)	57H,57L	1
0109-2	536303		MANIFOLD w/PLUG, INLET (4BARREL CARB)	16G8,6H,56B,56H,57B,57H	1
	G444734		PLUG, PIPE 1/4"	16G8,6H,56B,56H,57B,57H,57L	1
	534856		PLUG, CUP (FOR 534854 AND 1542825)	16G8,6H,56B,56H,57B,57H,57L	2
	G186285		SCREW, TO CYL. HEAD THRU CLAMP 3/8" -16X4"- NOTE 3	16G8.	4
	G179845		SCREW, TO CYL. HEAD THRU CLAMP 3/8" -16X1 3/4" } NOTE 4	16G8,6H,56B,56H,57B,57H,57L	4
	G180124		SCREW, TO CYL. HEAD 3/8" -16X1 1/4"	16G8,6H,56B,56H,57B,57H,57L	4
	41X243		WASHER, PLAIN 13/32"	16G8,6H,56B,56H,57B,57H,57L	4
0109-11	529349		CLAMP, TO CYL. HEAD - NOTE 3	16G8.	4
0109-11	535617P		CLAMP, TO CYL. HEAD - NOTE 4	16G8,6H,56B,56H,57B,57H,57L	4
0109-4	536194		MANIFOLD, RIGHT, EXHAUST.	16G8,6H,56B,56H,57B,57H,57L	1
0109-5	536195		MANIFOLD, LEFT, EXHAUST	16G8,6H,56B,56H,57B,57H,57L	1
	536214		SCREW, TO CYL. HEAD 3/8" -16X1 5/8"	16G8,6H,56B,56H,57B,57H,57L	12
	41X243		WASHER, PLAIN 13/32"	16G8,6H,56B,56H,57B,57H,57L	12
	-----		WASHER, SHAKEPROOF 3/8"	16G8,6H,56B,56H,57B,57H,57L	12
	37X212		STUD, RIGHT, EXHAUST PIPE FLANGE 3/8" -16-24X2 1/16"	16G8,6H,56B,56H,57B,57H,57L	2
	37X162		STUD, LEFT, EXHAUST PIPE FLANGE 3/8" -16-24X1 1/2"	16G8,6H,56B,56H,57B,57H,57L	2
	G114547		NUT, HEX. 3/8" -24	16G8,6H,56B,56H,57B,57H,57L	4
	41X243		WASHER, PLAIN 13/32"	16G8,6H,56B,56H,57B,57H,57L	4
0109-2	440893		MANIFOLD, INLET	56J	1
	G180124		SCREW, TO CYL. HEAD 3/8" -16X1 1/4"	56J	4
	360433		WASHER, PLAIN 3/8"	56J	4
	6480056		STUD, TO CYL. HEAD 3/8" -16-24X2"	56J	4
	433310		NUT, HEX 3/8" -24	56J	4
	427130		WASHER, PLAIN 13/32" I.D.	56J	4
0109-4	446741		MANIFOLD, RIGHT, EXHAUST	56J	1
0109-5	446740		MANIFOLD, LEFT, EXHAUST	56J	1
	440905		SCREW, TO CYL. HEAD 3/8" -16X1 3/4"	56J	12
	476024		LOCK PLATE, CENTER	56J	2
	476025		LOCK PLATE, END (EXCEPT GENERATOR END)	56J	3
	476026		LOCK PLATE, END (GENERATOR END)	56J	1
0109-7	1539404		EXTENSION, LEFT, EXHAUST MANIFOLD	56J	1
	G122138		SCREW, TO MANIFOLD 3/8" -16X1 1/8"	56J	2
0109-8	440575		GASKET, LEFT EXHAUST MANIFOLD EXTENSION	56J	1
	537967		GASKET SET, MANIFOLD - CONSISTS OF THE FOLLOWING GASKETS:	16G6,56G,57G	1
	1-196693		MANIFOLD	1-532733	CARBURETER
	1-680291		EXH. PIPE FLANGE		

NOTES { 3 - USED WITH CLAMP 4 3/4" LONG ON MODEL 16G8 SO.BEND CANADA
 BEFORE CAR SERIAL 8.383,854 8,958,243
 4 - USED WITH CLAMP 1 7/16" LONG ON MODEL 16G8 ON AND AFTER CAR SERIALS IN NOTE 3

ENGINE

0109

ILLUST. NUMBER	PART NUMBER	CHANGE	DESCRIPTION	MODELS	PER CAR	
<p>0109- INLET AND EXHAUST MANIFOLDS AND HEAT CONTROL- Cont'd. (Plates 01-5,7,9,11,12) MANIFOLDS-Cont'd.</p>						
536304			GASKET SET, MANIFOLD - CONSISTS OF THE FOLLOWING GASKETS:	16G6, 6H, 56B, 56H, 57B, 57H, 57L	1	
	2-530266		INLET MANIFOLD	2-536183	EXH. PIPE FLANGE	
	4-536003		EXH. MANIFOLD-END	1-536183	HEATER VALVE	
	2-536004		EXH. MANIFOLD-CENTER			
458673			GASKET SET, INLET MANIFOLD - CONSISTS OF THE FOLLOWING GASKETS:	56J	1	
	2-6480211		INLET MANIFOLD	1-440613	CARBURETER	
458672			GASKET SET, EXHAUST MANIFOLD - CONSISTS OF THE FOLLOWING GASKETS:	56J	1	
	4-446742		EXH. MANIFOLD-END	2-440866	EXH. PIPE FLANGE	
	2-446743		EXH. MANIFOLD-CENTER	1-440575	HEATER VALVE	
			INCL. IN SET			
0109-18	196693		GASKET, MANIFOLD TO CYL. BLOCK	537967	16G6, 56G, 57G	1
0109-19	530266		GASKET, INLET MANIFOLD TO CYL. HEAD.	536265-536304	16G8, 6H, 56B, 56H, 57B, 57H, 57L	2
0109-21-1	536003		GASKET, END, EXH. MANIFOLD TO CYL. HEAD.	536265-536304	16G8, 6H, 56B, 56H, 57B, 57H, 57L	4
0109-21-2	536004		GASKET, CENTER, EXH. MANIFOLD TO CYL. HEAD.	536265-536304	16G8, 6H, 56B, 56H, 57B, 57H, 57L	2
0109-19	6480211		GASKET, INLET MANIFOLD TO CYL. HEAD.	458670-458673	56J	2
0109-21-1	446742		GASKET, END, EXH. MANIFOLD TO CYL. HEAD.	458670-458672	56J	4
0109-21-2	446743		GASKET, CENTER, EXH. MANIFOLD TO CYL. HEAD.	458670-458672	56J	2
440885			SHIM, INLET MANIFOLD GASKET (USED WITH LOW COMPRESSION CYLINDER HEAD-EXPORT AND CANADA)	56J	2	
0109-22	680291		GASKET, EXHAUST PIPE FLANGE	16G6, 56G, 57G	1	
0109-22	536183		GASKET, EXHAUST PIPE FLANGE	16G8, 6H, 56B, 56H, 57B, 57H, 57L	2	
0109-22	440866		GASKET, EXHAUST PIPE FLANGE	56J	2	
MANIFOLD HEATER						
0109-27	536171		VALVE ASSY, COMPLETE, HEATER	16G8, 6H, 56B, 56H, 57B, 57H, 57L	1	
0109-27	440853		VALVE ASSY, COMPLETE, HEATER	56J	1	
0109-27	196655		VALVE AND SHAFT, HEATER	16G6, 56G, 57G	1	
0109-30	196658		SPACER, HEATER VALVE	16G6, 56G, 57G	1	
			INCL. IN SET			
0109-31	536183		GASKET, HEATER VALVE HOUSING	536265-536304	16G8, 6H, 56B, 56H, 57B, 57H, 57L	1
0109-31	440575		GASKET, HEATER VALVE HOUSING	458672	56J	1
0109-32	515832		COVER w/BUSHING, HEATER VALVE (INCL. STOP PIN)	16G6, 56G, 57G	1	
	G179816		SCREW, TO MANIFOLD 5/16" -18X3/4"	16G6, 56G, 57G	2	
	G120214		WASHER, LOCK 5/16"	16G6, 56G, 57G	2	
0109-33	196414		GASKET, HEATER VALVE COVER	16G6, 56G, 57G	1	
0109-37	515821		BUSHING, HEATER VALVE SHAFT	16G6, 56G, 57G	2	
0109-43	196662		BALANCE, HEATER VALVE	16G6, 56G, 57G	1	
0109-43	533122		BALANCE, HEATER VALVE	16G8, 6H, 56B, 56H, 57B, 57H, 57L	1	
0109-43	440750		BALANCE, HEATER VALVE	56J	1	
0109-44	199006		SET SCREW, 1/4" -20X9/16"	16G6, 56G, 57G	1	
	G139324		SET SCREW, 1/4" -20X5/16"	16G8, 6H, 56B, 56H, 57B, 57H, 57L	1	
	440778		PIN, GROOVE 3/32" X1/2"	56J	1	

NOTE { * - USE AS REQUIRED.

ENGINE

ILLUST. NUMBER	PART NUMBER	CHANGE	DESCRIPTION	MODELS	PER CAR
0109- INLET AND EXHAUST MANIFOLDS AND HEAT CONTROL- Cont'd. (Plates 01-5,7,9,11,12)					
MANIFOLD HEATER - Cont'd.					
0109-46	196661		THERMOSTAT, HEATER VALVE	16G6,56G,57G	1
0109-46	530009		THERMOSTAT, HEATER VALVE	16G8,6H,56B,56H,57B,57H,57L	1
0109-46	440753		THERMOSTAT, HEATER VALVE	56J	1
0109-47	525801		PIN, STOP 5/16" X 7/8" (PRESSED IN COVER)	16G6,56G,57G	1
	-----		PIN, STOP 5/32" X 1 1/4"	16G8,6H,56B,56H,57B,57H,57L	1
0115- OIL PAN, GASKETS, FILLER AND LEVEL GAGE (Plates 01-5,7,9)					
OIL PAN and GASKETS					
0115-1	533957		OIL PAN w/PLUG	16G6,56G,57G	1
0115-1	527145		OIL PAN w/PLUG - W-F-D-Y	16G8,6H	1
0115-1	531849		OIL PAN w/PLUG - C-K	16G8,6H	1
0115-1	1539382		OIL PAN w/PLUG	56B,56H,57B,57H,57L	1
0115-1	6480602		OIL PAN w/PLUG	56J	1
0115-2	510080		PLUG, DRAIN 3/4" -16	ALL EXCEPT 56J	1
0115-3	G113897		GASKET, PLUG	ALL EXCEPT 56J	1
0115-2	426205		PLUG, DRAIN 5/8" -18.	56J	1
	6480955		GASKET, PLUG	56J	1
	530312		SCREW AND WASHER, TO CYL. BLOCK 5/16" - 18X5/8"	16G6,56G,57G	18
	530312		SCREW AND WASHER, TO CYL. BLOCK 5/16" - 18X5/8"	16G8,6H,56B,56H	20
	G217232		SCREW AND WASHER, TO CYL. BLOCK 5/16" - 18X9/16"	56J	16
	G443609		SCREW AND WASHER, TO CYL. BLOCK 5/16" - 18X7/8"	56J	4
	471074		STUD, TO CYL. BLOCK 5/16" -24X1 7/16"	56J	2
	471074		STUD, TO CYL. BLOCK 5/16" -24X1 7/16" -w/AD-K7.	57H	2
	471074		STUD, TO CYL. BLOCK 5/16" -24X1 7/16" -w/AD	57L	2
	G120393		WASHER, PLAIN 11/32"	56J,57H,57L	2
	G120214		WASHER, LOCK 5/16"	56J,57H,57L	2
0115-6	535996		BLOCK, OIL PAN FILLER	16G6,56G,57G	1
0115-6	527123		BLOCK, OIL PAN FILLER	16G8,6H,56B,56H,57B,57H,57L	1
0115-9,10	535997		GASKET SET, OIL PAN }	16G6,56G,57G	1
0115-9,10	536559		GASKET SET, OIL PAN }	16G8,6H,56B,56H,57B,57H,57L	1
0115-9,9-1	458671		GASKET SET, OIL PAN }	56J	1
			CONSISTS OF 1 EA. RIGHT, LEFT, FRONT AND REAR GASKETS OR SEALS		
0115-9-1	476004		GASKET, FRONT, OIL PAN (INCL. IN 458671 SET)	56J	1
			INCL. IN SET		
0115-10	536614		GASKET, REAR, OIL PAN 535997	16G6,56G,57G	1
0115-10	536556		GASKET, REAR, OIL PAN 536559	16G8,6H,56B,56H,57B,57H,57L	1
0115-18	531000		CAP, OIL PAN FILLER (LESS AIR CONDITIONER)	ALL EXCEPT 56J	1
0115-18	537527		CAP, OIL PAN FILLER (w/AIR CONDITIONER).	16G8,6H,56B,56H,57B,57H	1
0115-18	194461		CAP, OIL PAN FILLER	56J	1
0115-20	525922		TUBE, OIL PAN FILLER	16G6,56G,57G.	1
0115-20	1539054		TUBE, OIL PAN FILLER	16G8,6H,56B,56H,57B,57H	1
0115-20	1542397		TUBE, OIL PAN FILLER (w/SUPERCHARGER) (ILLUST. PLATE 03-13)	57H,57L	1
0115-20	476062		TUBE, OIL PAN FILLER	56J	1
	G103877		PLUG, PIPE 1/8"	16G6,56G.	1
	G180079		SCREW, TO CYL. BLOCK 5/16" -18X1" (LESS AIR COND.)	16G8,6H,56B,56H,57B,57H,57L	2
	G120214		WASHER, LOCK 5/16"	16G8,6H,56B,56H,57B,57H,57L	2
0115-21	535697		GASKET, OIL PAN FILLER TUBE.	16G8,6H,56B,56H,57B,57H,57L	1

ENGINE

0116

ILLUST. NUMBER	PART NUMBER	CHANGE	DESCRIPTION	MODELS	PER CAR
----------------	-------------	--------	-------------	--------	---------

0115- OIL PAN, GASKETS, FILLER AND LEVEL GAGE Cont'd. (Plates 01-5,7,9)

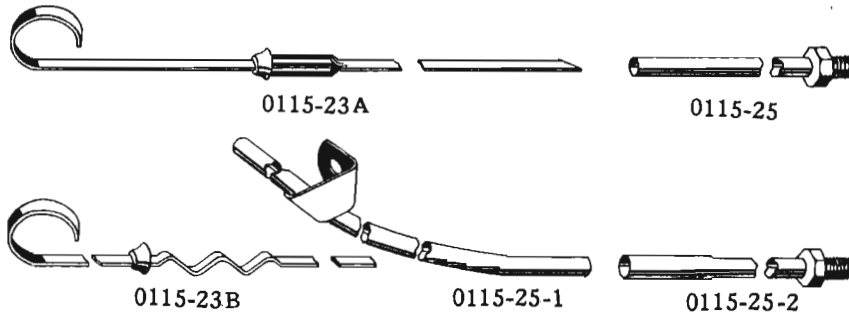

OIL LEVEL GAGE and TUBE

0115-23	534727	GAGE, OIL LEVEL	16G6, 56G, 57G.	1
0115-23B	533209	GAGE, OIL LEVEL - W-F-D-Y	16G8, 6H	1
0115-23A	533185	GAGE, OIL LEVEL - C-K	16G8, 6H	1
0115-23	1539890	GAGE, OIL LEVEL	56B, 56H, 57B, 57H, 57L	1
0115-23	440725	GAGE, OIL LEVEL	56J	1
0115-25	525895	TUBE, OIL LEVEL GAGE	16G6, 56G, 57G.	1
0115-25-1	533221	TUBE, UPPER, OIL LEVEL GAGE	16G8, 6H	1
0115-25-2	533220	TUBE, LOWER, OIL LEVEL GAGE } W-F-D-Y	16G8, 6H	1
0115-25	530994	TUBE, OIL LEVEL GAGE - C-K	16G8, 6H	1
0115-25-1	1539871	TUBE, UPPER, OIL LEVEL GAGE (INCLS. BRACKET).	56B, 56H, 57B, 57H, 57L	1
0115-25-2	533220	TUBE, LOWER, OIL LEVEL GAGE	56B, 56H, 57B, 57H, 57L	1
0115-25	440801	TUBE, OIL LEVEL GAGE	56J	1
0115-26	525898	RETAINER	16G6, 56G, 57G	1
0115-28	525897	WASHER, OIL LEVEL GAGE TUBE - FELT	16G6, 56G, 57G	1
	G137281	WASHER, OIL LEVEL GAGE TUBE - COPPER.	16G8, 6H, 56B, 56H, 57B, 57H, 57L	1

ENGINE BREATHER TUBE - SEE GROUP 0102

0116- OIL PUMP, STRAINER AND PRESSURE GAGE PIPES (Plates 01-5,7,9,13)

OIL PUMP

0116-1	521999	OIL PUMP KIT - CONSISTS OF:	16G6, 56G, 57G.	1
		1- - - - - BODY 4-G179829 FAST, SCREW		
		1-522072 COVER 4-G103320 LOCK WASHER		
		1-521371 COVER GASKET 1-519084 DRIVE SHAFT & GEAR		
		1-518913 DRIVER GEAR 1-194592 THRUST WASHER		
		1-G124543 KEY 1-518914 IDLER GEAR		
		1-195406 IDLER SHAFT		

ILLUST. NUMBER	PART NUMBER	CHANGE	DESCRIPTION	MODELS	PER CAR
0116- OIL PUMP, STRAINER AND PRESSURE GAGE PIPES-					
Cont'd. (Plates 01-5,7,9,13)					
OIL PUMP-Cont'd.					
0116-1	535760		OIL PUMP COMPLETE	16G8,6H	1
0116-1	1539412		OIL PUMP COMPLETE	56B,56H,57B,57H,57L	1
0116-1	6480508		OIL PUMP COMPLETE (INCL. OIL STRAINER)	56J	1
	37X167		STUD, TO REAR BEARING CAP 5/16" -18-24X1 3/8"	16G8,6H,56B,56H,57B,57H,57L	2
	G120368		NUT, HEX. 5/16" -24	16G8,6H,56B,56H,57B,57H,57L	2
	G120214		WASHER, LOCK 5/16"	16G8,6H,56B,56H,57B,57H,57L	2
	G100134		SCREW, TO REAR BEARING CAP 3/8" -16X1"	56J	2
	G120382		WASHER, LOCK 3/8"	56J	2
	440073		PIN, DOWEL, TO BEARING CAP 27/32" X 1 3/16"	56J	1
0116-3	----		BODY, OIL PUMP (NOT SOLD SEPARATELY).	ALL EXCEPT 56J.	1
	G103877		PLUG, PIPE 1/4"	16G6,56G,57G.	1
	G179829		SCREW, TO CYL. BLOCK 5/16" -18X2 3/4"	16G6,56G,57G.	4
	G120214		WASHER, LOCK 5/16"	16G6,56G,57G.	4
0116-3	440679		BODY, OIL PUMP (INCL. IDLER SHAFT)	56J	1
0116-5	195304		GASKET, OIL PUMP BODY	16G6,56G,57G.	1
0116-5	527224		GASKET, OIL PUMP BODY	16G8,6H,56B,56H,57B,57H,57L	1
0116-5	440988		GASKET, OIL PUMP BODY	56J	1
0116-8	522072		COVER, OIL PUMP BODY	16G6,56G,57G.	1
0116-8	531853		COVER, OIL PUMP BODY	16G8,6H	1
0116-8	1539479		COVER, OIL PUMP BODY	56B,56H,57B,57H,57L	1
0116-8	6480507		COVER, OIL PUMP BODY	56J	1
	G179793		SCREW, TO BODY 1/4" -20X5/8"	16G8,6H,56B,56H,57B,57H,57L	6
	G120380		WASHER, LOCK 1/4"	16G8,6H,56B,56H,57B,57H,57L	6
	G100109		SCREW, TO BODY 1/4" -20X3/4"	56J	6
	----		WASHER, LOCK 1/4"	56J	6
0116-9	521371		GASKET, OIL PUMP BODY COVER	16G6,56G,57G.	1
0116-12	519084		SHAFT, OIL PUMP DRIVE (INCL. DRIVE GEAR)	16G6,56G,57G.	1
0116-12	527155		SHAFT, OIL PUMP DRIVE (INCL. DRIVEN GEAR)	16G8,6H	1
0116-12	1539410		SHAFT, OIL PUMP DRIVE (INCL. DRIVEN GEAR)	56B,56H,57B,57H,57L	1
0116-12-1	440354		SHAFT, UPPER, PUMP DRIVE.	56J	1
0116-12-2	440600		SHAFT, LOWER, PUMP DRIVE.	56J	1
0116-12-3	440143		PIN, UPPER TO LOWER SHAFT 1/8" X 15/32"	56J	1
0116-13	440353		SLEEVE, OIL PUMP DRIVE SHAFT	56J	1
0116-13-1	G110741		PIN, TO SHAFT 1/8" X11/16"	56J	1
0116-14	195406		SHAFT, OIL PUMP IDLER GEAR	16G6,56G,57G.	1
0116-14	527158		SHAFT, OIL PUMP IDLER GEAR	16G8,6H,56B,56H,57B,57H,57L	1
0116-14	440601		SHAFT, OIL PUMP IDLER GEAR	56J	1
0116-16	199133		GEAR, OIL PUMP AND DISTRIBUTOR DRIVE.	16G6,56G,57G.	1
0601-44	----		GEAR, OIL PUMP AND DISTRIBUTOR DRIVE (SEE GROUP 0601)	ALL EXCEPT 16G6,56G,57G.	1
0116-17	156090		PIN, TO SHAFT 3/16" X27/32"	16G6,56G,57G.	1
0116-19	518913		GEAR, OIL PUMP DRIVEN	16G6,56G,57G.	1
0116-19	527159		GEAR, OIL PUMP DRIVEN (PRESSED ON SHAFT)	16G8,6H	1
0116-19	1539381		GEAR, OIL PUMP DRIVEN (PRESSED ON SHAFT)	56B,56H,57B,57H,57L	1
0116-19	440642		GEAR, OIL PUMP DRIVEN	56J	1
	G124543		KEY, WOODRUFF 1/8" X1/2"	16G6,56G,57G.	1
	G103905		KEY, WOODRUFF 1/8" X11/16"	56J	1
0116-20	518914		GEAR, OIL PUMP IDLER	16G6,56G,57G.	1
0116-20	527290		GEAR, OIL PUMP IDLER	16G8,6H	1
0116-20	1539381		GEAR, OIL PUMP IDLER	56B,56H,57B,57H,57L	1
0116-20	440681		GEAR, OIL PUMP IDLER	56J	1
0116-22	194592		THRUST WASHER, OIL PUMP DRIVE SHAFT	16G6,56G,57G.	1

ENGINE

0116

ILLUST. NUMBER	PART NUMBER	CHANGE <input checked="" type="checkbox"/>	DESCRIPTION	MODELS	PER CAR
0116- OIL PUMP, STRAINER AND PRESSURE GAGE PIPES-					
Cont'd. (Plates 01-6, 7, 9, 13)					
OIL PUMP-Cont'd.					
0116-27	533750		PIPE, OIL PUMP SUCTION - NOTE 5	16G6, 56G, 57G	1
0116-27	----		PIPE, OIL PUMP SUCTION - NOTE 6 (WELDED TO STRAINER)	57G	1
0116-27	1539597		PIPE, OIL PUMP SUCTION - NOTE 5	56B, 56H, 57B, 57H.	1
0116-27	----		PIPE, OIL PUMP SUCTION - NOTE 6 (WELDED TO STRAINER)	57B, 57H	1
0116-27	440728		PIPE, OIL PUMP SUCTION.	56J	1
0116-26	G179816		SCREW, TO CYL. BLOCK 5/16" - 18X3/4"	16G6, 56G, 57G	1
	G120214		WASHER, LOCK 5/16"	16G6, 56G, 57G	1
0116-28	534123		GASKET, OIL PUMP SUCTION PIPE	16G6, 56G, 57G	1
OIL STRAINER					
0116-30	187333		STRAINER, OIL - NOTE 5	16G6, 56G, 57G	1
0116-30	1541778		STRAINER, OIL - NOTE 6 (INCLS. SUCTION PIPE)	57G	1
0116-30	535784		STRAINER, OIL	16G8, 6H.	1
0116-30	440722		STRAINER, OIL - NOTE 5	56B, 56H, 56J, 57B, 57H.	1
0116-30	1541796		STRAINER, OIL - NOTE 6 (INCLS. SUCTION PIPE).	57B, 57H, 57L.	1
	----		COTTER 1/8" X 1 1/4" - NOTE 5	16G, 6H, 56G, 57G	1
OIL PRESSURE SIGNAL SWITCH					
0116-31	1539898		SWITCH, OIL PRESSURE SIGNAL - W-F-D-Y-P (ILLUST. PLATE 06-4)	56G, 56B, 56H, 57G, 57B, 57H, 57L	1
OIL PRESSURE GAGE PIPES					
0116-33	532630		PIPE W/NUTS, UPPER, OIL PRESSURE GAGE	16G6	1
0116-33	532630		PIPE W/NUTS, UPPER, OIL PRESSURE GAGE - C-K	56G, 57G.	1
	182099		NUT, PIPE (GAGE END) 1/8"	16G6, 56G, 57G	1
	----		NUT, PIPE (COUPLING END) 1/8"	16G6, 56G, 57G	1
	172651		CLIP, TO DASH - LHC.	16G6	1
	536795		CLIP, TO DASH - LHC.	56G, 57G.	1
0116-35	520400		PIPE W/NUTS, LOWER, OIL PRESSURE GAGE	16G6	1
0116-35	520400		PIPE W/NUTS, LOWER, OIL PRESSURE GAGE - C-K	56G, 57G.	1
	----		NUT, PIPE (COUPLING END) 1/8"	16G6, 56G, 57G	1
	G137396		NUT, PIPE (CYLINDER END) 1/8"	16G6, 56G, 57G	1
	643335		CLIP, TO CYLINDER	16G6, 56G, 57G	1
0116-33	532630		PIPE W/NUTS, OIL PRESSURE GAGE - EXCEPT K7.	16G8, 6H.	1
0116-33	527005		PIPE W/NUTS, OIL PRESSURE GAGE - K7	6H	1
0116-33	532630		PIPE W/NUTS, OIL PRESSURE GAGE - C-K.	56B, 56H, 56J, 57B, 57H.	1
	182099		NUT, PIPE (GAGE END) 1/8"	16G8, 6H, 56B, 56H, 56J, 57B, 57H	1
	----		NUT, PIPE (COUPLING END) 1/8"	16G8, 6H, 56B, 56H, 56J, 57B, 57H	1
	529401		CLIP, TO DASH	16G8, 6H.	1
	536795		CLIP, TO DASH - LHC.	56B, 56H, 56J, 57B, 57H.	1
	G137420		ELBOW, GAGE PIPE TO OIL PUMP	16G6	1
	G137420		ELBOW, GAGE PIPE TO OIL PUMP C-K.	56G, 57G.	1
0116-39	522329		COUPLING, GAGE PIPE FLEXIBLE	16G6	1
0116-39	530096		COUPLING, GAGE PIPE FLEXIBLE	16G8, 6H	1
0116-39	522329		COUPLING, GAGE PIPE FLEXIBLE .C.K.	56G, 57G	1
0116-39	530096		COUPLING, GAGE PIPE FLEXIBLE .C.K.	56B, 56H, 56J, 57B, 57H.	1
	G120395		WASHER, PLAIN 15/32" (UNDER CYL. HEAD SCREW)	16G6, 56G, 57G	1
	G141539		BUSHING, REDUCER	56J	1
0116-42	293762		GROMMET, GAGE PIPE DASH - LHC	16G, 6H	1
0116-42	293762		GROMMET, GAGE PIPE DASH - C-K - LHC	56G, 56B, 56H, 56J, 57G, 57B, 57H	1

NOTES {

5 - USED ON MODELS BEFORE ENGINE NOS. USA CANADA	57G 1,203,452 C-71,563	57B V-392,689 VC-10,914	57H P-42,946 PC-1,572	57H-K7 PS-1,963
6 - USED ON AND AFTER ENGINE NOS. IN NOTE 5				

ENGINE

ILLUST. NUMBER	PART NUMBER	CHANGE	DESCRIPTION	MODELS	PER CAR
0117- OIL PRESSURE RELIEF VALVE (Plates 01-5,7,9)					
0117-1	192136		VALVE, OIL PRESSURE RELIEF	ALL EXCEPT 56J	1
0117-1	440657		VALVE, OIL PRESSURE RELIEF	56J	1
0117-3	536670		SPRING, RELIEF VALVE	ALL EXCEPT 56J	1
0117-3	440784		SPRING, RELIEF VALVE	56J	1
0117-4	440655		RETAINER	56J	1
	-----		COTTER 1/8" X 1 1/4"	56J	1
0117-6	192124		PLUG, RELIEF VALVE	16G6, 56G, 57G	1
0117-6	527225		PLUG, RELIEF VALVE	16G8, 6H, 56B, 56H, 57B, 57H, 57L	1
0117-7	192125		GASKET, TO CYL. BLOCK	ALL EXCEPT 56J	1

0118- OIL FILTER AND PIPES (Plates 01-5,7,9)

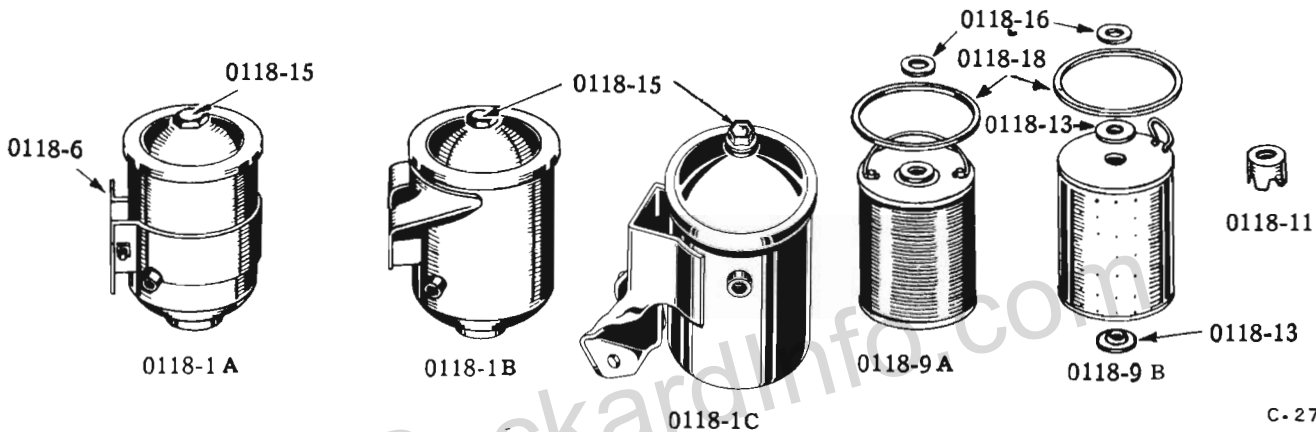

C-2724

OIL FILTER and CARTRIDGE - Replaceable Cartridge Type

AC-2130	MODEL F3-P2 OIL FILTER AND ATTACHING PARTS KIT	16G6, 56G	1
AC-2131	MODEL F4-P2 OIL FILTER AND ATTACHING PARTS KIT	16G6	1
AC-2749	MODEL F4- OIL FILTER AND ATTACHING PARTS KIT - HEAVY DUTY	56G, 57G	1
AC-2678	MODEL F4- OIL FILTER AND ATTACHING PARTS KIT	16G8, 56B, 57B	1
0118-1A	519836 OIL FILTER - MODEL F3	16G6, 56G	1
0118-1B	519834 OIL FILTER - MODEL F4 - HEAVY DUTY	16G6	1
0118-1B	532572X2 OIL FILTER - MODEL F4 - HEAVY DUTY	56G, 57G	1
	G179814 BOLT, TO BRACKET 5/16" -18X5/8"	16G6, 56G, 57G	2
	G120376 NUT, HEX. 5/16" -18	16G6, 56G, 57G	2
	G120393 WASHER, PLAIN 5/16"	16G6, 56G, 57G	2
	G120214 WASHER, LOCK 5/16"	16G6, 56G, 57G	2
0118-1B	532572X2 OIL FILTER, - MODEL F4	16G8, 6H, 56B, 56H, 57B, 57H	1
	G181595 BOLT, TO BRACKET 5/16" -24X3/4"	16G8, 6H, 56B, 56H, 57B, 57H	2
	G120368 NUT, HEX. 5/16" -24	16G8, 6H, 56B, 56H, 57B, 57H	2
	G120393 WASHER, PLAIN 5/16"	16G8, 6H, 56B, 56H, 57B, 57H	2
	G120214 WASHER, LOCK 5/16"	16G8, 6H, 56B, 56H, 57B, 57H	2
0118-1C	6489723 OIL FILTER	56J	1
	G122122 SCREW, TO CYL. HEAD 3/8" -16X3/4"	56J	2
	G120382 WASHER, LOCK 3/8"	56J	2
0118-4	525926 BRACKET, OIL FILTER SUPPORT	16G6, 56G, 57G	1
0118-4	536348 BRACKET, OIL FILTER SUPPORT	16G8, 6H, 56B, 56H, 57B, 57H	1
	G181348 BOLT, TO OIL FILLER TUBE	16G8, 6H, 56B, 56H, 57B, 57H	2
	G120368 NUT, HEX 1/4" -20	16G8, 6H, 56B, 56H, 57B, 57H	2
	G120214 WASHER, LOCK 1/4"	16G8, 6H, 56B, 56H, 57B, 57H	2

ENGINE

0118

ILLUST. NUMBER	PART NUMBER	CHANGE	DESCRIPTION	MODELS	PER CAR
0118- OIL FILTER AND PIPES-Cont'd. (Plates 01-5,7,9)					
OIL FILTER and CARTRIDGE - Replaceable Cartridge Type					
0118-6	519837		STRAP, OIL FILTER MOUNTING (FOR F3-P2 FILTER) . . .	16G6,56G	1
	-----		BOLT, CLAMPING 1/4" -20X3"	16G6,56G	1
	-----		NUT, HEX. 1/4" -20"	16G6,56G	1
	-----		WASHER, SHAKEPROOF 1/4"	16G6,56G	1
0118-9A	520829		CARTRIDGE KIT (FILCRON TYPE-FOR F3 FILTER) } CONSISTS OF	16G6,56G	1
0118-9A	SP-50090		CARTRIDGE KIT (FILCRON TYPE-FOR F4 FILTER) } CARTRIDGE &	ALL EXCEPT 56J,57L	1
0118-9B	SP-50053		CARTRIDGE KIT (WASTE TYPE - FOR F4 FILTER) } COVER	ALL EXCEPT 56J,57L	1
0118-9B	SP-50057		CARTRIDGE KIT	56J	1
				GASKET	
0118-11	520986		SUPPORT, OIL FILTER CARTRIDGE (FOR 196646)	ALL EXCEPT 56J,57L	1
0118-13	198276		GASKET, OIL FILTER CARTRIDGE (FOR 196646)	ALL EXCEPT 56J,57L	1
0118-15	198274		SCREW, OIL FILTER COVER 7/16" -20X1 1/4"	ALL EXCEPT 56J,57L	1
0118-16	192969		GASKET, SCREW	ALL EXCEPT 56J,57L	1
0118-18	197485		GASKET, OIL FILTER COVER (FOR F3 FILTER) } INCL. IN	16G6,56G	1
0118-18	521945		GASKET, OIL FILTER COVER (FOR F4 FILTER) } CARTRIDGE KIT	ALL EXCEPT 56J,57L	1
0118-18	440816		GASKET, OIL FILTER COVER	56J	1

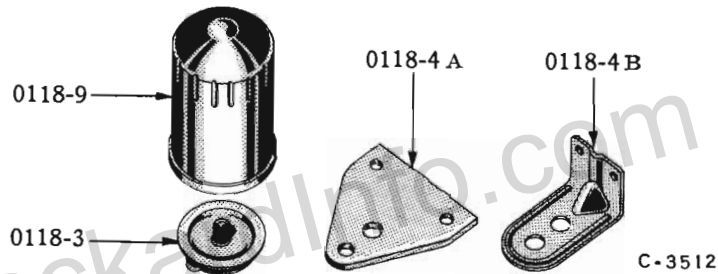

OIL FILTER - Sealed Can Type

AC-2848			OIL FILTER AND ATTACHING PARTS KIT	57G	1
AC-2854			OIL FILTER AND ATTACHING PARTS KIT	57B	1
-----			OIL FILTER	57G, 57B, 57H, 57L	1
G219758			NUT, TO BRACKET 3/4" -16"	57G, 57B, 57H, 57L	1
G115554			WASHER, SHAKEPROOF 3/4"	57G, 57B, 57H, 57L	1
0118-3	-----		BASE, OIL FILTER (NOT FURNISHED)	57G, 57B, 57H, 57L	1
0118-4A	1542741		BRACKET, OIL FILTER SUPPORT	57G	1
0118-4B	1542376		BRACKET, OIL FILTER SUPPORT	57B, 57H, 57L	1
	G181348		BOLT, TO OIL FILTER TUBE 5/16" -24X2 1/4"	57B, 57H	2
	G120368		NUT, HEX. 5/16" -24	57B, 57H	2
	G120214		WASHER, LOCK 5/16"	57B, 57H	2
	G180075		SCREW, TO AIR CHAMBER 5/16" -18 X 5/8" } w/SUPER-	57B, 57L	2
	G120214		WASHER, LOCK 5/16" } CHARGER	57B, 57L	2
0118-9	1542739		CAN OR CARTRIDGE, OIL FILTER	57G, 57B, 57H, 57L	1

OIL FILTER PIPES

0118-21	521902	●	PIPE, OIL FILTER INLET (FLEXIBLE)(ACCESSORY EQ.)	16G6,56G,57G	1
0118-21	1542744	■	PIPE, OIL FILTER INLET (FLEXIBLE)(ACCESSORY EQ.)	57G	1
0118-21	536792	●	PIPE, OIL FILTER INLET (FLEXIBLE)(ACCESSORY EQ.)	16G8,56B,57B	1
0118-21	532565	■	PIPE, OIL FILTER INLET (FLEXIBLE)(ACCESSORY EQ.)	57B	1
0118-21	536792	●	PIPE, OIL FILTER INLET (FLEXIBLE)(W/AIR CONDITIONER)	16G8,6H,56B,56H,57B,57H	1
0118-21	536351	●	PIPE w/NUTS, OIL FILTER INLET (LESS AIR CONDITIONER)	16G8,6H,56B,56H,57B,57H	1
0118-21	1542743	■	PIPE w/NUTS, OIL FILTER INLET (FACTORY INSTALLED).	57G	1
0118-21	1542666	■	PIPE w/NUTS, OIL FILTER INLET (FACTORY INSTALLED).	57B,57H	1

NOTES { ● FOR TYPE WITH REPLACEABLE CARTRIDGE.
 { ■ FOR TYPE WITH SEALED CAN.

ENGINE

ILLUST. NUMBER	PART NUMBER	CHANGE	DESCRIPTION	MODELS	PER CAR
0118- OIL FILTER AND PIPES-Cont'd. (Plates 01-5,7,9)					
OIL FILTER PIPES-Cont'd.					
0118-21	1542799	■	PIPE W/NUTS, OIL FILTER INLET (W/SUPERCHARGER)	57H, 57L	1
0118-21	6489720		PIPE W/NUTS, OIL FILTER INLET	56J	1
	G137396		NUT, PIPE 3/16"	16G8, 6H, 56B, 56H, 57B, 57H	2
	G137397		NUT, PIPE 1/4"	56J	2
0118-22	521903		BRACKET AND CLAMP, INLET PIPE TO HEAD (ACCESSORY)	16G6, 56G, 57G	1
	----		BOLT, CLAMPING No. 10-24X 3/8"	16G6, 56G, 57G	1
	G120361		NUT, HEX. No. 10-24	16G6, 56G, 57G	1
	G120395		WASHER, PLAIN 15/32" (UNDER HEAD SCREW)	16G6, 56G, 57G	1
	G106497		WASHER, SHAKEPROOF No. 10	16G6, 56G, 57G	1
0118-25	525927	●	PIPE, OIL FILTER OUTLET (FLEXIBLE)	16G6, 56G, 57G	1
0118-25	1542745	■	PIPE, OIL FILTER OUTLET (FLEXIBLE) (ACCESS. EQ.)	57G	1
0118-25	532565	●	PIPE, OIL FILTER OUTLET (FLEXIBLE)	16G8, 6H, 56B, 56H, 57B, 57H	1
0118-25	6489721		PIPE W/NUTS, OIL FILTER OUTLET	56J	1
0118-25	1542742	■	PIPE W/NUTS, OIL FILTER OUTLET (FACTORY INSTALLED)	57G	1
0118-25	1542667	■	PIPE W/NUTS, OIL FILTER OUTLET (LESS SUPERCHARGER)	57B, 57H	1
0118-25	1542800	■	PIPE W/NUTS, OIL FILTER OUTLET (W/SUPERCHARGER)	57H, 57L	1
	G137397		NUT, PIPE 1/4"	56J, 57G, 57B, 57H, 57L	2
	519846		CLIP, PIPE	57G	1
	G137421		ELBOW, INLET PIPE (FILTER END) (ACCESS. EQ.)	16G6, 56G, 57G	1
	G137420	■	ELBOW, INLET PIPE (FACTORY INSTALLED)	57G	2
	G137420	●	ELBOW, INLET PIPE	16G8, 6H, 56B, 56H, 57B, 57H	2
	G137420	■	ELBOW, INLET PIPE (CYL. END)	57B, 57H	1
	G137421		ELBOW, INLET PIPE (ACCESS. EQ.)	57B	1
	G137404	●	CONNECTOR, INLET PIPE (CYL. END)	56G, 57G	1
	G137405		CONNECTOR, INLET PIPE (HEAD END)	56J	1
	G137404	■	CONNECTOR, INLET PIPE (FILTER END)	57B, 57H	1
	G137404	■	CONNECTOR, INLET PIPE (W/SUPERCHARGER)	57H, 57L	2
	G137421		ELBOW, OUTLET PIPE (LESS SUPERCHARGER)	ALL EXCEPT 56J, 57L	2
	G137421		ELBOW, OUTLET PIPE (FILTER END)	56J	1
	G137405		CONNECTOR, OUTLET PIPE (CYLINDER END)	56J	1
	G137405		CONNECTOR, OUTLET PIPE (W/SUPERCHARGER)	57H, 57L	2
		●	FOR TYPE WITH REPLACEABLE CARTRIDGE.		
		■	FOR TYPE WITH SEALED CAN.		